



I-4 and Sand Lake Road Interchange Design-Build

05/21/2025



Status as of May 19, 2025

Days Used	Total Days	% Days Complete	Last Contract Day
778	1,479	52.6%	04/20/2027

Sand Lake 3470				Current Week								Week 1								Week 2							
Activity ID	Activity Description	Foreman / Sub	Supt	19-May	20-May	21-May	22-May	23-May	24-May	25-May	26-May	27-May	28-May	29-May	30-May	31-May	1-Jun	2-Jun	3-Jun	4-Jun	5-Jun	6-Jun	7-Jun	8-Jun			
				MON	TUE	WED	THU	FRI	SAT	SUN	MON	TUE	WED	THU	FRI	SAT	SUN	MON	TUE	WED	THU	FRI	SAT	SUN			
	Roadway																										
	Level Pad/Strapcone 6-2	Kyle Sample	Sample	X	X																						
	Demo Mill Exist. Ramp M	Kyle Sample	Sample			X	X	X																			
	Ex/Grade Pond 206	Kyle Sample	Sample									X	X	X	X			X	X	X	X	X					
EW380	Ramp K R.O.W. Adjustments	Dennis Scott	Sample								X	X	X														
	Ramp K Embankment	Dennis Scott	Sample										X	X	X												
	Ramp K Stone (Temp)	Dennis Scott	Sample															X	X								
	Support Blount Sanford (Ex/Grade/Backfill: I4 WB/Ramp M)	Dennis Scott	Sample															X	X	X	X	X					
	Approach Slab Base Bridge 1/2 (South side)	Dennis Scott	Sample									X	X	X	X												
	Dewater Pond 206	Dennis Scott	Sample	X	X																						
	Grade for North Sidewalk	Dennis Scott	Sample			X	X	X																			
STAB240/STAB260	Grade Stab I4 WB 4217 - 4245 (North)	Jessie Wilson	Sample	X	X	X																					
BASE270	Place/Finish Lime Rock I4 WB sta. 4217 - 4245 (North)	Jessie Wilson	Sample				X	X	X		X	X	X	X	X	X											
	Mix/Plc/Balance I4 WB 4189 - 4214 (South)	Jessie Wilson	Sample															X	X	X	LBR	LBR	LBR				
	Grade Stab Ramp M3 3317 - 3325	Jessie Wilson	Sample																		X	X	X				
	Pre & Post work Ramp M Eyebrow swap																										
	Thermo striping	McShae		N	N	N																					
	Drainage / Utilities																										
	S-110 Turkey Lake	Jose Castro C.	Greg Lemire	X	X	X	X																				
	S-1110A Turkey Lake	Jose Castro C.	Greg Lemire					X	X																		
	S111A Turkey Lake	Jose Castro C.	Greg Lemire								X	X	X	X													
	S-117 Turkey Lake	Jose Castro C.	Greg Lemire												X	X		X	X	X							
	S-119 Turkey Lake	Jose Castro C.	Greg Lemire																		X	X	X				
	Install S-810 to S-807 42" Pipe	Edward	Greg Lemire	X	X	X	X	X	X																		
	Install S-807 tp S-327	Edward	Greg Lemire								X	X	X	X	X	X											
	Install S-518 to S-515	Edward	Greg Lemire															X	X	X	X	X	X				
	Install S808 to S-325 18" Pipe	Jonathan	Greg Lemire	X	X	X	X	X	X																		
	Install S-808 to S-810 42" Pipe	Jonathan	Greg Lemire								X	X	X	X	X	X											
	Install S-319 to S-319OF	Jonathan	Greg Lemire	X	X	X	X	X																			
U-OUC300	Remove existing WM with drainage install	Jonathan	Greg Lemire	X	X	X	X	X																			
	Structures																										
	Form pylon 1-1	victor medina	jose perez	X	X	X	X	X			X	X	X	X	X	X		X	X	P							
AS100	Form approach slab B1	victor medina	jose perez					X	X		X	X	P														
	Form approach slab B2	victor/fransico	jose perez											X	X	X		X	X	X	P						
BW220/230	F/G junction/ form junction slab W103/w102	rafael	jose perez	X	X	P	P	X			X	X	X	X	X												
	Form coping build up W103,W102	rafael	jose perez	X	X	P	X	X			X	X	X	X	X												
	Form closure W102&W103	rafael	jose perez								X	X	X	X	X			X	X	X	X	X					
	Set precast W102	Rafael	Jose P	X	X	X	X	X	X									X	X	X	X	X	X				
	Set precast W103	Rafael	Jose P								X	X	X	X	X	X											
	Subs																										
	Install MSE Wall 6-2	RWH Crew 1	Nate				X	X			X	X	X	X	X			X	X	X	X	X					
MSE250	Install MSE Wall 102	RWH Crew 1	Nate	X	X	X																					
	Demo Mill Ramp M	Trans Premier	Nate			X	X	X																			
	Shoulder Barrier (WB/Ramp J)	JVD	Roberto															X	X	X	X	X					
	Median Barrier Wall I4 WB N	Blount Sanford	Roberto															X	X	X	X	X					
	Median Barrier Wall I4 WB S	Blount Sanford	Roberto															X	X	X	X	X					
	Ramp J Pipe Videos	APS	Rainer	N																							
	Bridge 750485 Repulice Drive - I-4 WB - Existing Girders	Finishing Systems	Medani	N	N	N	N			N	N	N	N	N													
	Bridge 750485 Repulice Drive - Adventure Way Off Ramp - Existing Girders	Finishing Systems	Medani														N	N	N	N							
	Bridge 750485 Repulice Drive - SB Kirkman Rd On Ramp to I-4 WB - Existing Girders	Finishing Systems	Medani																					N			
	Lighting																										
	MSE Wall 102 Conduit and LP Anchor Bolts	Conti	Rainer	X	X	X	X	X			X	X	X	X	X												

Sand Lake 3470				Current Week								Week 1								Week 2							
Activity ID	Activity Description	Foreman / Sub	Supt	19-May	20-May	21-May	22-May	23-May	24-May	25-May	26-May	27-May	28-May	29-May	30-May	31-May	1-Jun	2-Jun	3-Jun	4-Jun	5-Jun	6-Jun	7-Jun	8-Jun			
				MON	TUE	WED	THU	FRI	SAT	SUN	MON	TUE	WED	THU	FRI	SAT	SUN	MON	TUE	WED	THU	FRI	SAT	SUN			
	Aesthetic Lighting	Conti	Rainer	X																							
	ITS																										
	ITS Pullboxes I-4WB Sta: 1554 - 1479	Conti	Rainer															X	X	X	X	X					
	ITS Conduit I-4 EB Sta: 1433 - 1330	Conti/Vasi	Rainer															X	X	X	X	X					
	ITS Conduit I-4 WB Sta: 1554 - 1479	Conti/Vasi	Rainer								X	X	X	X	X												
	MSE Wall 1-1 and 103 Conduit	Conti	Rainer					X							X												
	Signage																										
	Ramp M Ped Poles	Conti	Rainer		X	X	X	X			X	X															
	SPM																										
	Ramp K GMS	Conti	Rainer								X	X	X	X	X												
	Ramp K Remove Strain Poles	Conti	Rainer															X	X	X	X	X					
	Utilities	UTILITY OWNER	STA																								
	Fiber Relocation: Splice/Cutoff (Gravity Wall/Widening)	ATT	TLR	X	X																						
	Fiber Relocation (Gravity Wall/Widening)	Spectrum	TLR			N	N				N	N															
	Fiber Relocation (Gravity Wall/Widening)	Comcast	TLR										N	N				N	N								
	Fiber Relocation (Gravity Wall/Widening)	Smart City	TLR																	N	N						
	Fiber Relocation (Gravity Wall/Widening)	Verizon	TLR																								
	Fiber Relocation (Temp Critical Wall)	Comcast	SLR	X	X	X	X	X			X	X	X														
	Fiber Relocation (SLR Jack & Bore)	Summit	SLR	X	X	X	X	X			X	X															
	Gas Line Relocation (24" WM)	Teco	SLR								X	X	X	X	X												
	Fiber Relocation (24" WM)	Zayo	SLR															X	X	X	X	X					
	Sand Lake Officers Scheduled																										
	FHP		Nate	X	X	X	X	X	X	X	X	X	X	X	X	X											
	Sand Lake Road Closures / Sidewalk																										
	Sand Lake Rd & Ramps																										
	Ramp J Full Closure	APS	Jamey	N-C																							
	Ramp K opening (6/1/25)																X										
	I-4 WB (8/01/25)																										
	I-4 WB																										
	I-4 Double Lane Closures WB	Finishing Systems	Jamey	N-C	N-C	N-C	N-C																				
	I-4 WB Express Lanes Single	Finishing Systems	Jamey	N-C	N-C	N-C	N-C																				



Phillips
Crossing

Rosen Inn
International





Agenda — Current Project Status

- **Past Project Status — FDOT to review past 7 days**
 - Shift to new westbound I-4 exit ramp path
 - Demo old ramp (Area 3)
 - Bridge form removal (Areas 1, 2, and 3)
 - Install temporary traffic signals
 - Jack and bore (Areas 1 and 3)
 - Lighting (Areas 2, 3, 5, 6, and 7)
 - Turkey Lake Road median widening
 - Thermoplastic striping on Sand Lake Road
 - Continue installing MSE walls (Areas 2 and 3)
 - Place lime rock (Areas 2 and 3)
 - Dewater (Area 3)
 - Utility relocation
 - Ongoing mowing and litter pickup
- **Committee's Comments & Suggestions**



New WB I-4 Off Ramp to Sand Lake Road





New WB I-4 Off Ramp to Sand Lake Road





New WB I-4 Off Ramp: Signage





Agenda — Future Project Status

- **Future Project Status — FDOT to review next 7 days**
 - Demolish old ramp (Area 3)
 - Jack and bore (Areas 1 and 3)
 - Bridge form removal (Areas 1, 2, and 3)
 - Continue installing MSE walls (Areas 2 and 3)
 - Place lime rock (Areas 2 and 3)
 - Embankment work (Areas 5 and 6)
 - Lighting (Areas 2, 3, 5, 6, and 7)
 - Turkey Lake Road median widening
 - Utility relocation
 - Ongoing mowing and litter pickup
- **Committee's Comments & Suggestions**



Agenda — Future Project Status

- **Future Project Status — FDOT to review next 14 – 21 days**
 - Demolish old ramp (Area 3)
 - Grade pond (Area 3)
 - Bridge form removal (Areas 1, 2, and 3)
 - Continue installing MSE walls (Areas 2 and 3)
 - Turkey Lake median widening
 - Utility relocation
 - Ongoing mowing and litter pickup
- **Committee's Comments & Suggestions**



Agenda — Cleanliness Review

- **Cleanliness Review**
 - Committee's observations over past 7 days
- **Condition Review**
 - Committee's observations over past 7 days
(fencing, wraps, barricades, temporary signage)



Agenda — Old Business

- **Public Input or Comments**
- **Commitments Update**
 - Fencing and screening
 - Mowing and cleaning
 - Clean Team
 - Ponds



Safety Diversions

- Eastbound I-4 under S.R. 528
- Westbound I-4 to eastbound S.R. 528
 - May 21 – 23
 - 10 p.m. – 6 a.m.

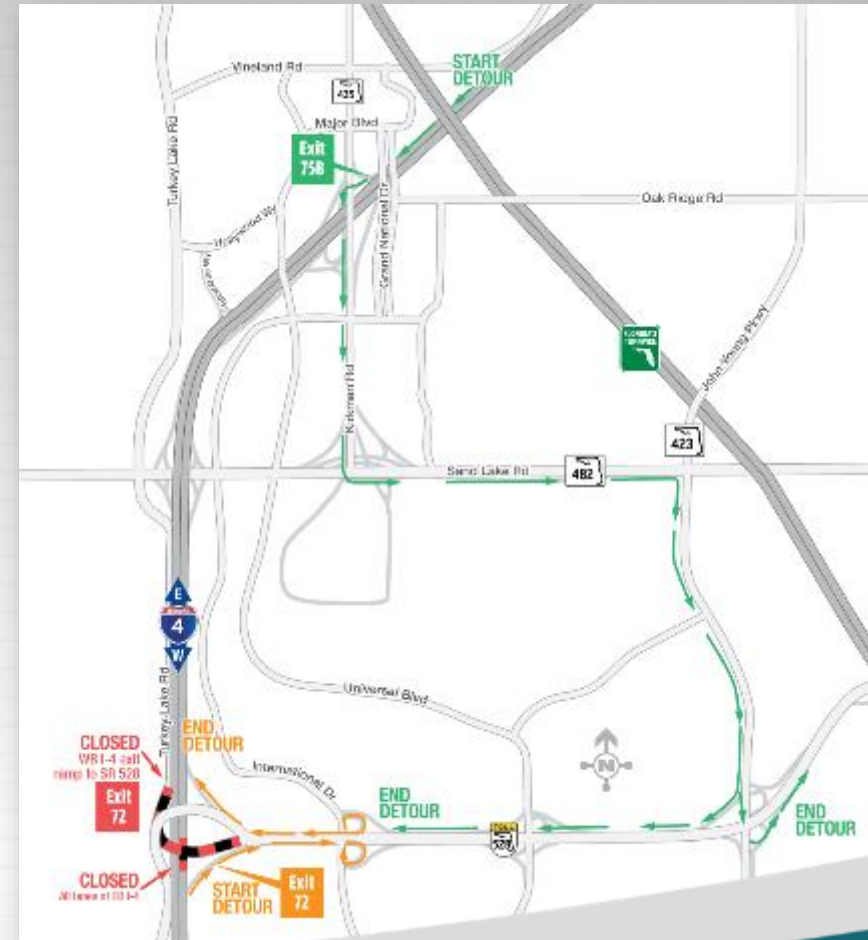



Agenda — New Business

- Next meeting: 05/28/25