



# I-4 and Sand Lake Road Interchange Design-Build

05/07/2025



# Status as of May 5, 2025

Days Used	Total Days	% Days Complete	Last Contract Day
764	1,479	51.7%	04/20/2027

Sand Lake 3470				Current Week								Week 1								Week 2					
Activity ID	Activity Description	Foreman / Sub	Supt	5-May	6-May	7-May	8-May	9-May	10-May	11-May	12-May	13-May	14-May	15-May	16-May	17-May	18-May	19-May	20-May	21-May	22-May	23-May	24-May	25-May	
	Roadway																								
	Ramp M2 Eyebrow opening (prerequisite)	Kyle Sample	Sample								X	X	X	X											
EW430	RW102/103	Kyle Sample	Sample	X	X	X	X	X																	
	Embankment WB 4189 - 4214	Kyle Sample	Sample	X	X	X	X	X																	
	Demo Mill Exist. Ramp M	Kyle Sample	Sample															X	X						
	Ex/Grade Pond 206	Kyle Sample	Sample																	X	X	X	X		
EW480	Ramp K Relocate Utilities	Conti	Rainer					X																	
	Ramp K Embankment	Dennis Scott	Sample								X	X	X		X	X									
	Ramp K Stone (Temp)	Dennis Scott	Sample											X	X	X									
	Support Blount Sanford (Ex/Grade/Backfill: 14 WB/Ramp M)	Dennis Scott	Sample	X	X	X	X	X																	
STAR120	Approach Slab Base Bridge 1/2 (South side)	Dennis Scott	Sample	X	X	X	X	X																	
	Grade Stab 14 WB 4217 - 4245 (North)	Jessie Wilson	Greg Lemire	X	X	X	X	X																	
	Place/Finish Lime Rock 14 WB sta. 4217 - 4245 (North)	Jessie Wilson	Greg Lemire						X		X	X	X	X	X	X									
	Mix/Plc/Balance 14 WB 4189 - 4214 (South)	Jessie Wilson	Greg Lemire															X	X	X	LBR	LBR			
	Night Mot V Erosion Deficiency Items	Jamie L	Greg Lemire	X	X	X	X	X																	
	Pre & Post work Ramp M Eyebrow swap														N										
	Asphalt	Hubbard	Nate		X	X	X																		
	Prestripe	McShae	Nate					X	X		X														
	Guardrail	ACME	Roberto					X	X		X														
	Temp Signs	ACME	Roberto			X	X	X						X	X										
	Predrill sign holes	Dennis Scott	Tyler	X																					
	Prestand post ramp M and Nose	Dennis Scott	Tyler			X	X																		
	Signal Poles (9) Ramp M	Conti	Rainer	N	N						N	N													
	Signal Heads (10) Ramp M	Conti	Rainer			N	N	N			N	N													
	Street Lights (8) Ramp M	Conti	Rainer		X	X	X	X			X														
	Relocate ext wrong way	Conti	Rainer																						
	Sign Relocates Ramp M	Conti	Rainer		X	X	X	X			X	X	X	X											
	Test Signals Ramp M	Conti	Rainer												N										
	Pre Tape Sandlake	McShae	Nate/Roberto			N	N																		
	Switch Traffic	Lane	Lemire/Sample												N										
	Switch Traffic	Conti	Rainer/Barton												N										
	Switch Traffic	TCP/ACME/McSHAE	Nate/Roberto												N										
	Thermo striping	McShae															N	N	N	N					
EW6100	Drainage / Utilities																								
	Install S-531 to S-526	Jose Castro C.	Greg Lemire				X	X	X																
	Install S-334 to S-335 18" pipe	Jose Castro C.	Greg Lemire								X	X	X												
	Install S-202	Jose Castro C.	Greg Lemire	X	X	X																			
-	Install S-203	Jose Castro C.	Greg Lemire																						
	Install S-204	Jose Castro C.	Greg Lemire								X	X	X												
	Install S-229 to S-231	Jose Castro C.	Greg Lemire											X	X	X									
	S-110 Turkey Lake	Jose Castro C.	Greg Lemire															X	X	X	X				
-	S-1110A Turkey Lake	Jose Castro C.	Greg Lemire																			X	X		
	Install S-241A to S-809 48" Pipe	Edward	Greg Lemire	X	X	X	X	X	X																
	Install S-809 to S-811 48" Pipe	Edward	Greg Lemire								X	X	X	X	X	X									
	Install S-241A to S-809 48" Pipe	Jonathan	Greg Lemire	X																					
-	Install S-809 to S-811 48" Pipe	Jonathan	Greg Lemire		X	X	X																		
	Install S-811 to S-812 48" Pipe	Jonathan	Greg Lemire					X	X		X	X													
	Install S-812 to S-808 48" Pipe	Jonathan	Greg Lemire										X	X	X	X									
	Install S808 to S-325 18" Pipe	Jonathan	Greg Lemire															X	X	X	X	X	X	X	
	Install S-319 to S-319OF	Jonathan	Greg Lemire															X	X	X	X	X	X		
	Remove existing WM with drainage install	Jonathan	Greg Lemire	X	X	X	X	X	X		X	X	X	X	X	X		X	X	X	X	X	X		
	Structures																								
	F/G junction/ form junction slab W103/w102	Francisco	Jose perex			X	X	X	X		X	X	X	X	X			X	X	X	X	X			
	Form coping build up W103,W102	Francisco	Jose P	X	P	X	X	X	X		X	X	X	X	X			X	X	X	X	X			
	form closer W102&W103	Francisco	Jose perex										X	X	X	X		X	X	X	X	X			
	form coping plain under b1	Victor Medina	Jose P										X	X	X			X	X	X					
	approach slab 1 B1	Victor Medina	Jose P	X	X	X	X	X			X	X													
	set precast W102	Rafael	Jose P	X	X	X	X	X	X		X	X	X	X	X	X									
	set precast W103	Rafael	Jose P	X	X	X	X																		
	Subs																								
MSE250	Install MSE Wall 6-2	RWH Crew 1	Nate															X	X	X	X	X			
	Install MSE Wall 102	RWH Crew 1	Nate	X	X	X	X	X			X	X	X	X	X										
	Shoulder Barrier (WB/Ramp J)	JVD	Roberto								X	X	X	X	X										
	Shoulder Barrier (WB South)	JVD		X	X	X	X																		
	Half-Wall (RW1-S)	JVD	Roberto					X																	
	Median Barrier Wall 14 WB N	Blount Sanford	Roberto	X	X	X					X														
	Median Barrier Wall 14 WB S	Blount Sanford					X	X																	
	Bridge 750485 Repulice Drive - I-4 EB Toll - Existing Girders	Finishing Systems	Medani	N	N	N																			
	Bridge 750485 Repulice Drive - I-4 WB Toll - Existing Girders	Finishing Systems	Medani							N	N	N	N												
	Bridge 750485 Repulice Drive - I-4 WB - Existing Girders	Finishing Systems	Medani														N	N	N	N				N	

Sand Lake 3470				Current Week								Week 1								Week 2							
Activity ID	Activity Description	Foreman / Sub	Supt	5-May	6-May	7-May	8-May	9-May	10-May	11-May	12-May	13-May	14-May	15-May	16-May	17-May	18-May	19-May	20-May	21-May	22-May	23-May	24-May	25-May			
				MON	TUE	WED	THU	FRI	SAT	SUN	MON	TUE	WED	THU	FRI	SAT	SUN	MON	TUE	WED	THU	FRI	SAT	SUN			
	Lighting																										
	Ramp M Shoulder Lights	Conti	Rainer	X							X																
	Bridge 6 Underdeck Conduit	Conti	Rainer	X							X																
	ITS																										
	Ramp M Temp Bore	Conti/Vasi	Rainer	X	X	X	X	X																			
	Ramp M WWD5	Conti	Rainer	X	X	X	X	X																			
	Ramp M WWD5 Tapco Test	Conti	Rainer								X	X															
	MSE Wall 1-1 and 103 Conduit	Conti	Rainer												X							X					
	Signals																										
	Ramp M/SLR Signal Head	Conti	Rainer	X	X	X	X	X																			
	SPM																										
	Ramp K GMS	Conti	Rainer															X	X	X	X	X					
	Ramp M GMS	Conti	Rainer	X	X	X	X	X			X	X															
	Ramp M MOT Shift																										
	Signals and Signage Final Install and Review	Conti	Rainer																								
	Utilities	USMC/overseas	SIA													N-C											
	Pole Relocation: Gravity Wall (1/20 -5/14/ 25: 64 Days UWS)	Duke	TLR	X	X	X	X				X	X	X	X													
	Fiber Relocation	Summit	SLR								X	X	X	X	X												
	Fiber Relocation	ATT	TLR	X	X	X	X	X			X	X	X	X	X												
	Fiber Relocation	Spectrum	SLR	X	X	X	X	X																			
	Pole Relocation: Gravity Wall 1st	Spectrum	TLR															X	X	X	X	X					
	Pole Relocation: Gravity Wall 2nd	Comcast	TLR																								
	Pole Relocation: Gravity Wall 3rd	Smart City	TLR																								
	Pole Relocation: Gravity Wall 4th	Verizon	TLR																								
	Sand Lake Road Closures /																										
	Sand Lake Rd 8 Ramps																										
	Ramp J Full Closure	Lane	Jamey	N-C	N-C	N-C	N-C			N-C	N-C	N-C	N-C	N-C													
	Ramp M Full Closure	Lane	Jamey	N-C	N-C	N-C	N-C			N-C	N-C	N-C	N-C	N-C													
	Ped Opening South Side (4/9/25)																										
	Ramp K opening (6/1/25)																										
	Ramp M1 Eyebrow opening (5/9/25)																										
	I-4 WB (8/01/25)																										
	I-4 EB																										
	I-4 Double Lane Closures EB	Finishing Systems	Jamey	N-C	N-C	N-C	N-C																				
	I-4 EB Express Lanes Single	Finishing Systems	Jamey	N-C	N-C	N-C	N-C																				
	I-4 WB																										
	I-4 Double Lane Closures WB	Finishing Systems	Jamey	N-C	N-C	N-C	N-C			N-C	N-C	N-C	N-C	N-C													
	I-4 WB Express Lanes Single	Finishing Systems	Jamey	N-C	N-C	N-C	N-C			N-C	N-C	N-C	N-C	N-C													



Phillips Crossing

Rosen Inn International





# Agenda — Future Project Status

- **Past Project Status — FDOT to review past 7 days**
  - Bridge form removal (Areas 1, 2, and 3)
  - Install temporary traffic signals
  - Lighting (Areas 2, 3, 5, 6, and 7)
  - Turkey Lake Road median widening
  - Continue installing MSE walls (Areas 2 and 3)
  - Maintaining existing and installing new Wrong-Way Vehicle Detection Systems (Area 3)
  - Embankment work (Areas 2 and 3)
  - Utility relocation
  - Ongoing mowing and litter pickup
- **Committee's Comments & Suggestions**



# Agenda — Future Project Status

- **Future Project Status — FDOT to review next 7 days**
  - Shift to new westbound I-4 exit ramp path
  - Bridge form removal (Areas 1, 2, and 3)
  - Continue installing MSE walls (Areas 2 and 3)
  - Maintaining existing and installing new Wrong-Way Vehicle Detection Systems (Area 3)
  - Place lime rock (Areas 2 and 3)
  - Embankment work (Areas 6 and 7)
  - Lighting (Areas 2, 3, 5, 6, and 7)
  - Turkey Lake Road median widening
  - Utility relocation
  - Ongoing mowing and litter pickup
- **Committee's Comments & Suggestions**



# Westbound I-4 Exit Ramp: New Path





# Agenda — Future Project Status

- **Future Project Status — FDOT to review next 14 – 21 days**
  - Demo old ramp (Area 3)
  - Thermo striping on Sand Lake Road
  - Bridge form removal (Areas 1, 2, and 3)
  - Continue installing MSE walls (Areas 2 and 3)
  - Turkey Lake median widening
  - Utility relocation
  - Ongoing mowing and litter pickup
- **Committee's Comments & Suggestions**



# Agenda — Cleanliness Review

- **Cleanliness Review**
  - Committee's observations over past 7 days
- **Condition Review**
  - Committee's observations over past 7 days  
(fencing, wraps, barricades, temporary signage)



# Agenda — Old Business

- **Public Input or Comments**
- **Commitments Update**
  - Fencing and screening
  - Mowing and cleaning
  - Clean Team
  - Ponds



# Safety Diversions

- Westbound I-4 ramps for Sand Lake Road
  - May 7 – 9 and 11 – 16
  - 10 p.m. – 5 a.m.

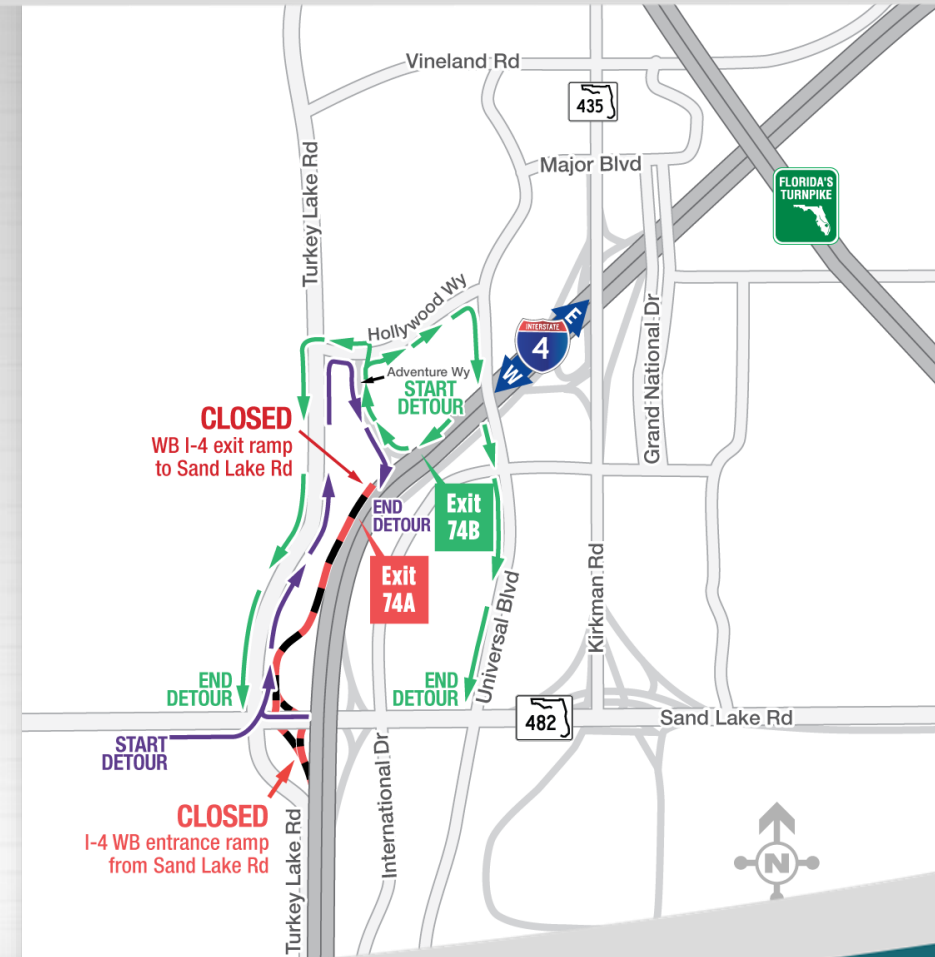



# Safety Diversions

- Westbound I-4 exit ramp to eastbound S.R. 528
- Eastbound I-4 under S.R. 528
  - May 6 – 9
  - 10 p.m. – 5 a.m.

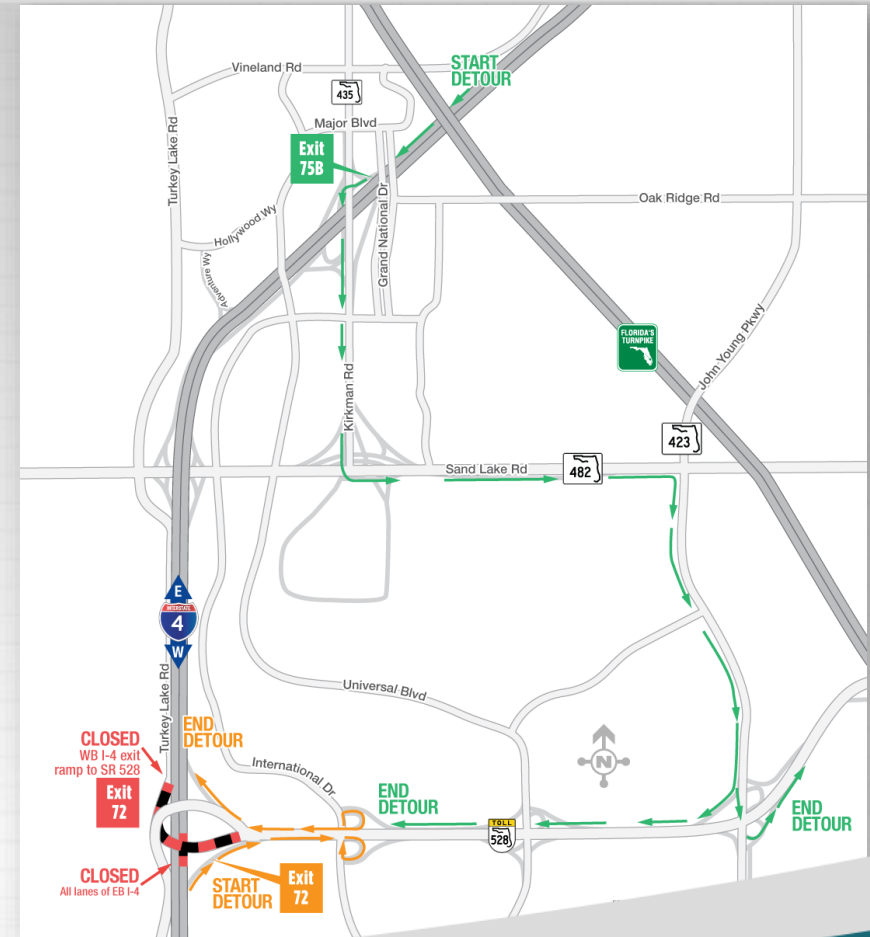



# Agenda — New Business

- **Next meeting: Engineering conference on 05/14/25**
  - Move to another day next week?
  - Cancel altogether?