



# BUILDING A BETTER I-4

## Stay Informed:

- » Project Hotline: 321-329-8444
- » Follow @i4beyond on X
- » Subscribe to our monthly newsletter at [fdot.tips/i4news](https://fdot.tips/i4news)
- » Subscribe to our YouTube channel at [youtube.com/@i4beyond](https://youtube.com/@i4beyond)

## New Traffic Pattern Now Open on Daryl Carter Parkway Overpass

A new traffic pattern is now open on the Daryl Carter Parkway overpass, marking an important milestone on the Interstate 4 (I-4) and Daryl Carter Parkway improvement project. The overpass features a new diverging diamond traffic pattern, with motorists crossing to the left side of the road at a traffic signal before crossing back to the right side of the road at a second signal.

### Improved Safety and Congestion Relief

When the project's ramps are completed, this pattern will eliminate left turns across traffic and reduce conflict points — places where vehicles cross paths or merge. In the interim, it will give crews a safer work zone to complete ramp, median, and sidewalk work. This work is part of the project to transform the Daryl Carter Parkway overpass into a new diverging diamond interchange (DDI), providing congestion relief to adjacent interchanges and improving connectivity to Central Florida's attractions area.

## Construction Schedule and Continuing Improvements at Daryl Carter Parkway

Construction crews closed the Daryl Carter Parkway overpass from March 16 to 19 to complete the necessary road work to implement the diverging diamond. The overpass will remain in this configuration until the new ramps — exit ramps from both directions of I-4 and an eastbound I-4 entrance ramp — open later this spring, completing the final footprint of the new I-4 interchange.

Construction on the project began in 2022 and is expected to be completed in summer 2025. Construction schedules are subject to change due to weather or other unforeseen circumstances.

### Additional Improvements

The project also includes improvements on I-4. Crews are constructing a single, buffer-separated, westbound express lane from west of Central Florida Parkway to west of Daryl Carter Parkway. The finished I-4 Express extension will run from west of Sand Lake Road to west of State Road (S.R.) 536 and will be constructed in three separate projects.



To learn more about the benefits of DDIs, visit [i4beyond.com/darylcarter](https://i4beyond.com/darylcarter)



# How to Navigate the New Diverging Diamond at Daryl Carter Parkway

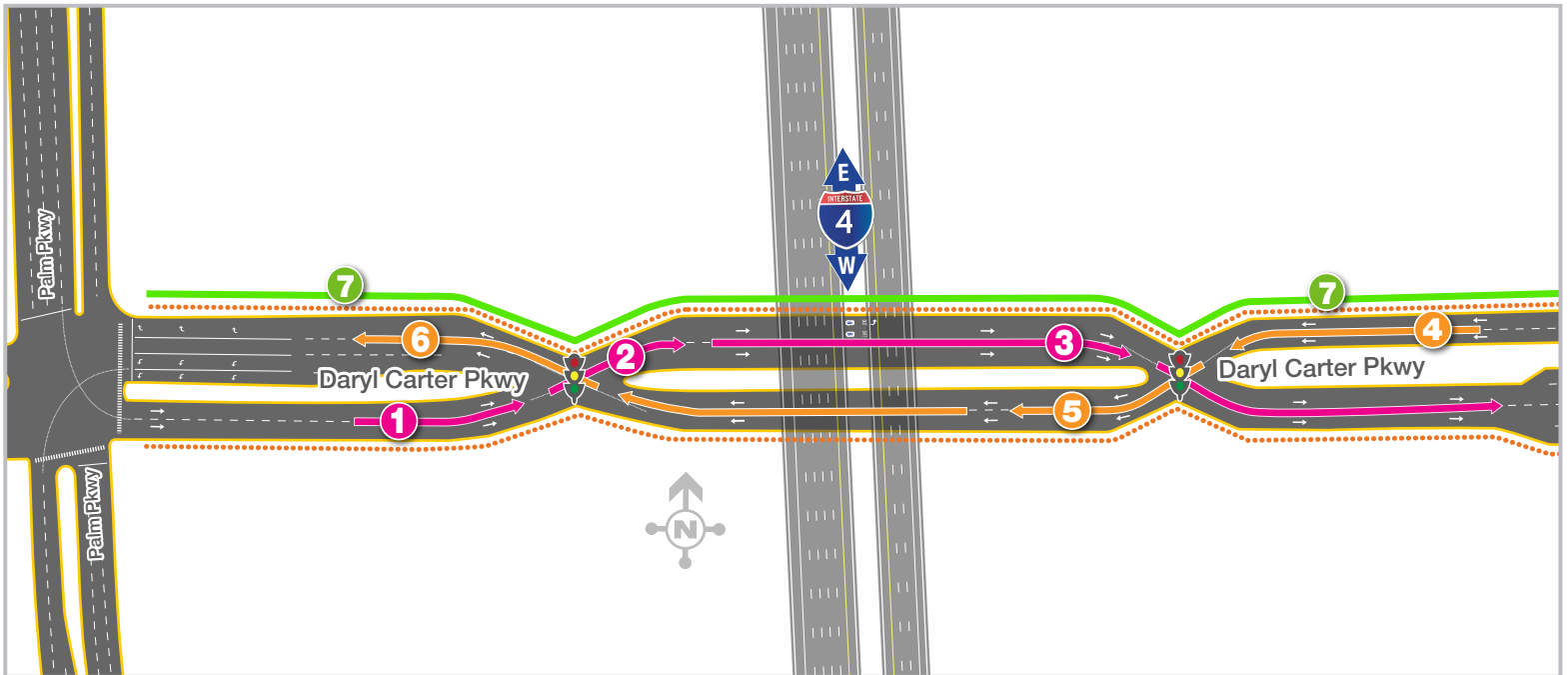

1

Motorists traveling eastbound on Daryl Carter Parkway should proceed through the first traffic signal.

2

Motorists will cross to the left side of the road at the first signal.

3

Motorists will encounter a second traffic signal after traveling over Interstate 4, where they will cross back over to the right side.

4

Motorists traveling westbound should proceed through the first signal.

5

Motorists will cross to the left side of the road at the first signal.

6

Motorists will cross back over to the right side of the road at the second signal.

7

During this traffic phase, pedestrians walking along Daryl Carter Parkway will be directed to use the sidewalk on the north side of the overpass while crews complete work on the south side.



To learn more about the benefits of DDIs, visit  
[i4beyond.com/darylcarter](https://www.flhwy.com/i4beyond.com/darylcarter)

