



# I-4 and Sand Lake Road Interchange Design-Build

02/19/2025



# Status as of February 17, 2025

Days Used	Total Days	% Days Complete	Last Contract Day
687	1,477	46.5%	04/18/2027

[illegible]



Sand Lake 3470				Current Week						Week 1						Week 2								
Activity ID	Activity Description	Foreman / Sub	Supt	17-Feb	18-Feb	19-Feb	20-Feb	21-Feb	22-Feb	23-Feb	24-Feb	25-Feb	26-Feb	27-Feb	28-Feb	1-Mar	2-Mar	3-Mar	4-Mar	5-Mar	6-Mar	7-Mar	8-Mar	9-Mar
				MON	TUE	WED	THU	FRI	SAT	SUN	MON	TUE	WED	THU	FRI	SAT	SUN	MON	TUE	WED	THU	FRI	SAT	SUN
	<u>Lighting</u>																							
	Lighting Maintenance Ramp J Sign	Conti	Rainer			X	X	X																
	MSE Wall 6-1	Conti	Rainer					X							X									
	Ramp K Lighting	Conti	Rainer								X	X	X	X	X									
	Ramp M Graivty Wall Conduit & Embedded Boxes	Conti	Rainer			X							X											
	Ramp M Shoulder Lights	Conti	Rainer								X	X	X	X	X			X	X	X	X	X		
	<u>ITS</u>																							
	ITS Pullboxes I-4WB Sta: 1554 - 1479	Conti	Rainer	X	X	X	X	X			X	X	X	X	X									
	ITS Conduit I-4 EB Sta: 1554 - 1479	Conti/Synergy	Rainer								X	X	X	X	X			X	X	X	X	X		
	Ramp M WWDS	Conti	Rainer															X	X	X	X	X		
	Ramp K WWDS	Conti	Rainer															X	X	X	X	X		
	Ramp K Temp ITS Pole 73.3-EB-B	Conti	Rainer										X	X										
	MSE Wall 1-1 and 103	Conti	Rainer					X							X							X		
	<u>SPM</u>	Conti	Rainer																					
	Ramp K GMS	Conti	Rainer											X	X			X	X	X	X	X		
	Ramp K Cantilever Removal	Conti	Rainer								X	X	X											
	<u>Aesthetic Lighting</u>																							
	Pylon Bores CIP 1-2	Conti/Synergy	Rainer								X	X	X	X	X									
	<u>Utilities</u>	UTILITY OWNER	STA																					
	Pole Relocation: Gravity Wall (1/20 -5/14/25: 64 Days UWS)	Duke	TLR	N	N	N	N				N	N	N	N				N	N	N	N			
	Fiber Relocation	Crown Castle	SLR								X	X	X	X										
	<b>Sand Lake Road Closures /</b>																							
	<u>Sand Lake Rd &amp; Ramps</u>																							
	Sandlake Rd Singles WB	Dennis	Jamey																					
	Sandlake Rd Singles EB	Dennis	Jamey																					
	Sand Lake Contra-Flow WB	Dennis	Jamey								N-C	N-C	N-C	N-C	N-C			N-C	N-C	N-C	N-C	N-C		N-C
	Sand Lake Contra-Flow EB	Dennis	Jamey								N-C	N-C	N-C	N-C	N-C			N-C	N-C	N-C	N-C	N-C		N-C
	Singal Outside Right Lane Ramp K	Dennis/APS	Jamey	N-C																				
	<u>I-4 EB</u>																							
	I-4 Single Lane Closures EB Outside	Dennis	Jamey																					
	I-4 Lane Closures EB Double Inside Lanes DMS 74.5 North of SLR	Conti	Jamey																					
	<u>I-4 WB</u>																							
	I-4 Single Lane Closures WB Inside (TCP)	TCP	Jamey				N-C				N-C													
	I-4 Single Lane Closures WB Outside (TCP) & (Traffic Shift)	Dennis	Jamey				N-C				N-C													
	<u>Central Florida PKWY</u>																							
	Full Detour CFP (12:30AM to 5:30AM)	Dennis	Jamey																					

N/P - Night Pour	T-N - Tentative
X - Day Schedule	N - Night
NC - Night Time Confirmed	D-Pile Delivery
C - Confirmed or Cure	





Phillips  
Crossing

Rosen Inn  
International























# Agenda — Past Project Status

- **Past Project Status — FDOT to review past 7 days**
  - Installing barriers on bridges over Sand Lake Road (Areas 2 and 3)
  - Bridge deck installation (Areas 1, 2, and 3)
  - Pile driving (near Central Florida Parkway)
  - Turkey Lake median widening
  - Place embankment (Area 3)
  - Continue installing MSE walls (Area 1)
  - Remove existing water main
  - Utility relocation
  - Ongoing mowing and litter pickup
- **Committee's Comments & Suggestions**





# Agenda — Future Project Status

- **Future Project Status — FDOT to review next 7 days**
  - Bridge deck installation (Areas 1, 2, and 3)
  - Place lime rock on loop ramp (Area 3)
  - Place temporary embankment (Areas 2 and 3)
  - Continue installing MSE walls (Area 1)
  - Turkey Lake median widening
  - Lighting (Areas 6 and 7)
  - Remove existing water main
  - Utility relocation
  - Ongoing mowing and litter pickup
- **Committee's Comments & Suggestions**





# Agenda — Future Project Status

- **Future Project Status — FDOT to review next 14 – 21 days**
  - Maintaining existing and installing new Wrong-Way Vehicle Detection Systems (Areas 3, 6, and 7)
  - Bridge deck installation (Areas 1, 2, and 3)
  - Place lime rock on loop ramp (Area 3)
  - Continue installing MSE walls (Area 1)
  - Place temporary embankment (Areas 2 and 3)
  - Turkey Lake median widening
  - Lighting (Areas 6 and 7)
  - Remove existing water main
  - Utility relocation
  - Ongoing mowing and litter pickup
- **Committee's Comments & Suggestions**





# Agenda — Cleanliness Review

- **Cleanliness Review**
  - Committee's observations over past 7 days
- **Condition Review**
  - Committee's observations over past 7 days  
(fencing, wraps, barricades, temporary signage)





# Agenda — Old Business

- **Public Input or Comments**
- **Commitments Update**
  - Bridge underdeck lighting
  - Fencing and screening
  - Mowing and cleaning
  - Clean Team
  - Ponds





# Agenda — Old Business

- Bridge deck pours over Sand Lake Road
  - Bridge 1
    - Early March
    - Overnight











# Agenda — New Business

- **S.R. 528 ramp widening**
  - **Bridge deck pour safety diversions**
    - **Westbound I-4 from Adventure Way to Central Florida Parkway**
      - **March 2**
      - **10 p.m. – 6 a.m.**
    - **Eastbound I-4 at S.R. 528**
      - **March 6**
      - **10 p.m. – 6 a.m.**





# S.R. 528 Safety Diversions

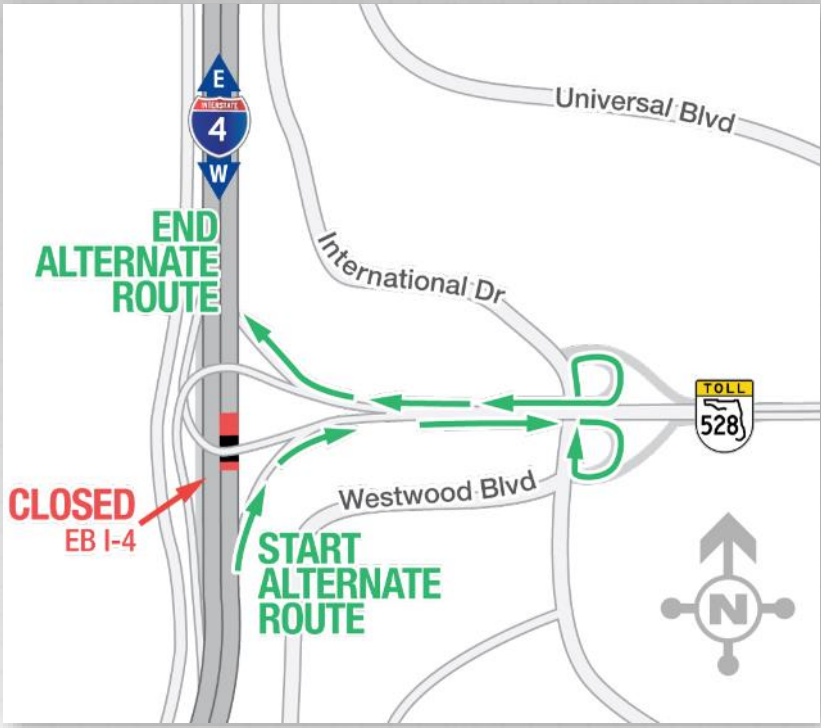
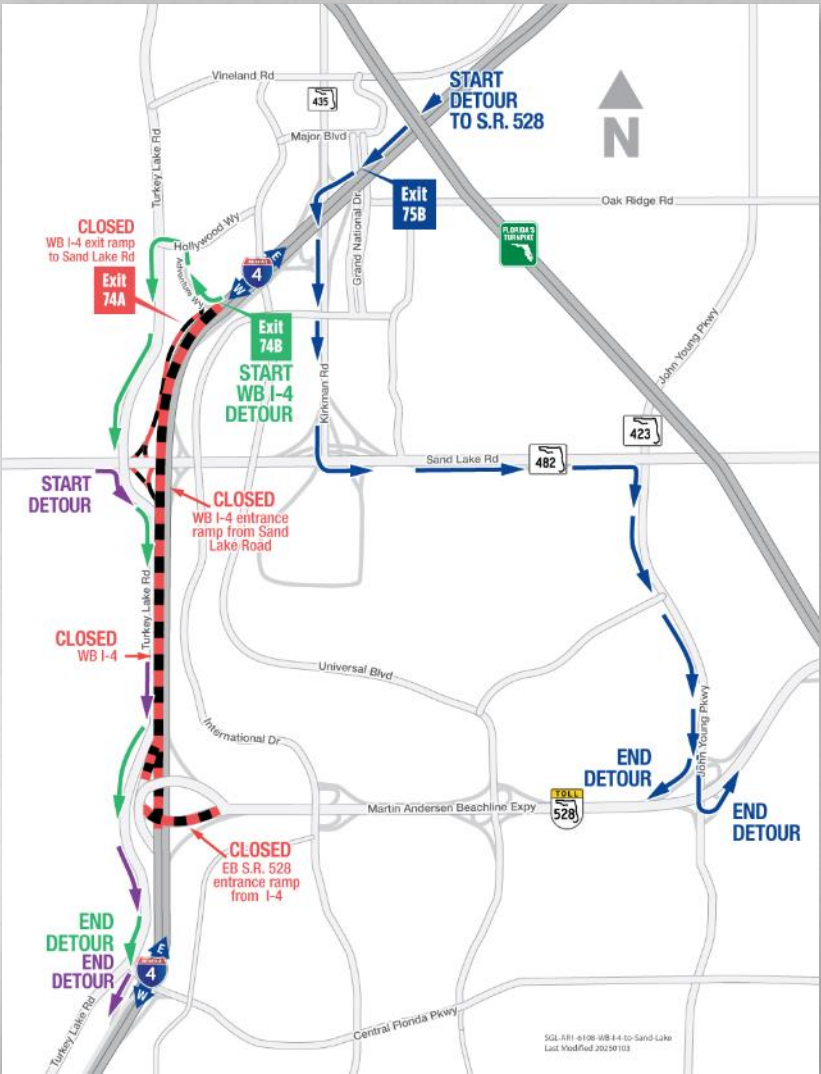





# Agenda — New Business

- Next meeting: 02/26/25