

STATE OF FLORIDA
DEPARTMENT OF TRANSPORTATION

CONTRACT PLANS

FINANCIAL PROJECT ID 439682-2-52-01

SEMINOLE COUNTY (77160)

STATE ROAD NO. 400 (I-4)

SIGNING AND PAVEMENT MARKING PLANS

INDEX OF SIGNING AND PAVEMENT MARKING PLANS

<i>SHEET NO.</i>	<i>SHEET DESCRIPTION</i>
S-1	KEY SHEET
S-2 - S-3	TABULATION OF QUANTITIES
S-4	GENERAL NOTES
S-5 - S-18	SIGNING AND PAVEMENT MARKING SHEETS
S-19	GUIDE SIGN WORKSHEET

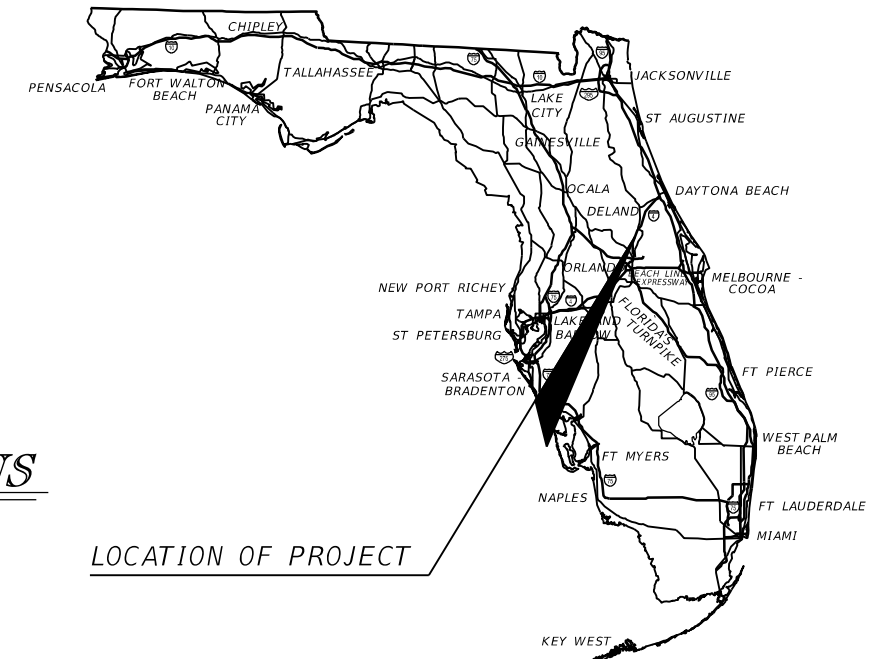

LOCATION OF PROJECT

PHASE II SUBMITTAL
JULY 16, 2018

**SIGNING AND PAVEMENT
MARKING PLANS**
ENGINEER OF RECORD:

JESSICA RENFROW, P.E.
P.E. NO.: 80363
METRIC ENGINEERING, INC.
615 CRESCENT EXECUTIVE CT, SUITE 524
LAKE MARY, FLORIDA 32746
TEL. (407) 644-1898
FAX. (407) 644-2376
CONTRACT NO.: E7R08
VENDOR NO.: F-59-1685550
CERTIFICATE OF AUTHORIZATION NO.: 2294

FDOT PROJECT MANAGER:
HATEM AGUIB, P.E.

CONSTRUCTION CONTRACT NO.	FISCAL YEAR	SHEET NO.
TBD	20	S-1

TABULATION OF QUANTITIES

PAY ITEM NO.	DESCRIPTION	UNIT	SHEET NUMBERS												TOTAL THIS SHEET		GRAND TOTAL			
			S-5		S-6		S-7		S-8		S-9		S-10		S-11		PLAN	FINAL	PLAN	FINAL
			PLAN	FINAL	PLAN	FINAL	PLAN	FINAL	PLAN	FINAL	PLAN	FINAL	PLAN	FINAL						
700-3-101	SIGN PANEL, F&I GROUND MOUNT, UP TO 12 SF	EA			1												1			
700-3-601	SIGN PANEL, REMOVE, UP TO 12 SF	EA			1												1			
700-3-603	SIGN PANEL, REMOVE, 21-30 SF	EA			1												1			
700-3-626	SIGN PANEL, REMOVE, 101-200 SF WITH LIGHTING	EA			1												1			
706-3	RETRO-REFLECTIVE PAVEMENT MARKERS, WHITE-RED	EA	113		204		80		166		173		105		105		946			
706-3	RETRO-REFLECTIVE PAVEMENT MARKERS, YELLOW-RED	EA			14		6		20		12						52			
710-11-101	PAINTED PAVEMENT MARKINGS, STANDARD, WHITE, SOLID, 6"	GM	0.233		0.364		0.307		0.402		0.356		0.265		0.265		2.193			
710-11-102	PAINTED PAVEMENT MARKINGS, STANDARD, WHITE, SOLID, 8"	GM																		
710-11-103	PAINTED PAVEMENT MARKINGS, STANDARD, WHITE, SOLID FOR INTERCHANGE MARKINGS, 12"	GM			0.304				0.261		0.254						0.819			
710-11-123	PAINTED PAVEMENT MARKINGS, STANDARD, WHITE, SOLID FOR CROSSWALK AND ROUNDABOUT, 12"	LF																		
710-11-124	PAINTED PAVEMENT MARKINGS, STANDARD, WHITE, SOLID, 18"	LF			23												23			
710-11-125	PAINTED PAVEMENT MARKINGS, STANDARD, WHITE, SOLID FOR STOP LINE OR CROSSWALK, 24"	LF																		
710-11-131	PAINTED PAVEMENT MARKINGS, STANDARD, WHITE, SKIP, 10-30 SKIP, 6" WIDE	GM	0.698		0.655		0.573		0.530		0.578		0.795		0.795		4.625			
710-11-170	PAINTED PAVEMENT MARKINGS, STANDARD, WHITE, ARROWS	EA																		
710-11-201	PAINTED PAVEMENT MARKINGS, STANDARD, YELLOW, SOLID, 6"	GM	0.233		0.363		0.308		0.413		0.356		0.265		0.265		2.204			
711-11-103	THERMOPLASTIC, STANDARD, WHITE, SOLID, 12" FOR INTERCHANGE MARKINGS	GM			0.304				0.261		0.254						0.819			
711-11-124	THERMOPLASTIC, STANDARD, WHITE, SOLID, 18" FOR DIAGONALS AND CHEVRONS	LF			23												23			
711-11-125	THERMOPLASTIC, STANDARD, WHITE, SOLID, 24" FOR STOP LINE AND CROSSWALK	LF																		
711-11-141	THERMOPLASTIC, STANDARD, WHITE, 2-4 DOTTED GUIDELINE/ 6-10 GAP EXTENSION, 6"	GM																		
711-11-170	THERMOPLASTIC, STANDARD, WHITE, ARROW	EA																		
711-14-123	THERMOPLASTIC, PREFORMED, WHITE, SOLID, 12" FOR CROSSWALK	LF																		
711-14-125	THERMOPLASTIC, PREFORMED, WHITE, SOLID, 24" FOR CROSSWALK	LF																		
711-16-101	THERMOPLASTIC, STANDARD-OTHER SURFACES, WHITE, SOLID, 6"	GM	0.233		0.364		0.307		0.402		0.356		0.265		0.265		2.193			
711-16-102	THERMOPLASTIC, STANDARD-OTHER SURFACES, WHITE, SOLID, 8"	GM																		
711-16-131	THERMOPLASTIC, OTHER SURFACES, WHITE, SKIP, 6", 10-30 SKIP OR LANE DROP	GM	0.698		0.655		0.573		0.530		0.578		0.795		0.795		4.625			
711-16-201	THERMOPLASTIC, STANDARD-OTHER SURFACES, YELLOW, SOLID, 6"	GM	0.233		0.363		0.308		0.413		0.356		0.265		0.265		2.204			

REVISIONS				JESSICA RENFROW, P.E. P.E. LICENSE NUMBER 80363 METRIC ENGINEERING, INC. 615 CRESCENT EXECUTIVE CT, SUITE 524 LAKE MARY, FLORIDA 32746 CERTIFICATE OF AUTHORIZATION: 2294	STATE OF FLORIDA DEPARTMENT OF TRANSPORTATION			TABULATION OF QUANTITIES	SHEET NO.
DATE	DESCRIPTION	DATE	DESCRIPTION		ROAD NO.	COUNTY	FINANCIAL PROJECT ID		
					400	SEMINOLE	439682-2-32-01		S-2

THE OFFICIAL RECORD OF THIS SHEET IS THE ELECTRONIC FILE DIGITALLY SIGNED AND SEALED UNDER RULE 61G15-23.004, F.A.C.

TABULATION OF QUANTITIES

PAY ITEM NO.	DESCRIPTION	UNIT	SHEET NUMBERS														TOTAL THIS SHEET		GRAND TOTAL	
			S-12		S-13		S-14		S-15		S-16		S-17		S-18		PLAN	FINAL	PLAN	FINAL
			PLAN	FINAL	PLAN	FINAL	PLAN	FINAL	PLAN	FINAL	PLAN	FINAL	PLAN	FINAL						
700-3-101	SIGN PANEL, F&I GROUND MOUNT, UP TO 12 SF	EA																	1	
700-3-601	SIGN PANEL, REMOVE, UP TO 12 SF	EA																	1	
700-3-603	SIGN PANEL, REMOVE, 21-30 SF	EA																	1	
700-3-626	SIGN PANEL, REMOVE, 101-200 SF WITH LIGHTING	EA																	1	
706-3	RETRO-REFLECTIVE PAVEMENT MARKERS, WHITE-RED	EA	105		114		183		242		123		72		243		1082		2028	
706-3	RETRO-REFLECTIVE PAVEMENT MARKERS, YELLOW-RED	EA							17		29		36		53		135		187	
710-11-101	PAINTED PAVEMENT MARKINGS, STANDARD, WHITE, SOLID, 6"	GM	0.264		0.265		0.265		0.387		0.491		0.268		0.728		2.668		4.861	
710-11-102	PAINTED PAVEMENT MARKINGS, STANDARD, WHITE, SOLID, 8"	GM									0.035				0.080		0.115		0.115	
710-11-103	PAINTED PAVEMENT MARKINGS, STANDARD, WHITE, SOLID FOR INTERCHANGE MARKINGS, 12"	GM					0.053		0.304						0.428		0.785		1.604	
710-11-123	PAINTED PAVEMENT MARKINGS, STANDARD, WHITE, SOLID FOR CROSSWALK AND ROUNDABOUT, 12"	LF									117						117		117	
710-11-124	PAINTED PAVEMENT MARKINGS, STANDARD, WHITE, SOLID, 18"	LF													229		229		252	
710-11-125	PAINTED PAVEMENT MARKINGS, STANDARD, WHITE, SOLID FOR STOP LINE OR CROSSWALK, 24"	LF									170				36		206		206	
710-11-131	PAINTED PAVEMENT MARKINGS, STANDARD, WHITE, SKIP, 10-30 SKIP, 6" WIDE	GM	0.792		0.795		1.004		0.964		0.148		0.268		0.113		4.084		8.709	
710-11-170	PAINTED PAVEMENT MARKINGS, STANDARD, WHITE, ARROWS	EA									23				8		31		31	
710-11-201	PAINTED PAVEMENT MARKINGS, STANDARD, YELLOW, SOLID, 6"	GM	0.265		0.265		0.265		0.386		0.219		0.268		0.398		2.067		4.271	
711-11-103	THERMOPLASTIC, STANDARD, WHITE, SOLID, 12" FOR INTERCHANGE MARKINGS	GM					0.053		0.304						0.428		0.785		1.604	
711-11-124	THERMOPLASTIC, STANDARD, WHITE, SOLID, 18" FOR DIAGONALS AND CHEVRONS	LF													229		229		252	
711-11-125	THERMOPLASTIC, STANDARD, WHITE, SOLID, 24" FOR STOP LINE AND CROSSWALK	LF									49				36		85		85	
711-11-141	THERMOPLASTIC, STANDARD, WHITE, 2-4 DOTTED GUIDELINE/ 6-10 GAP EXTENSION, 6"	GM									0.016				0.014		0.030		0.030	
711-11-170	THERMOPLASTIC, STANDARD, WHITE, ARROW	EA									23				8		31		31	
711-14-123	THERMOPLASTIC, PREFORMED, WHITE, SOLID, 12" FOR CROSSWALK	LF									117						117		117	
711-14-125	THERMOPLASTIC, PREFORMED, WHITE, SOLID, 24" FOR CROSSWALK	LF									121						121		121	
711-16-101	THERMOPLASTIC, STANDARD-OTHER SURFACES, WHITE, SOLID, 6"	GM	0.264		0.265		0.265		0.387		0.491		0.268		0.728		2.668		4.861	
711-16-102	THERMOPLASTIC, STANDARD-OTHER SURFACES, WHITE, SOLID, 8"	GM									0.035				0.080		0.115		0.115	
711-16-131	THERMOPLASTIC, OTHER SURFACES, WHITE, SKIP, 6", 10-30 SKIP OR LANE DROP	GM	0.792		0.795		1.004		0.964		0.148		0.268		0.113		4.084		8.709	
711-16-201	THERMOPLASTIC, STANDARD-OTHER SURFACES, YELLOW, SOLID, 6"	GM	0.265		0.265		0.265		0.386		0.219		0.268		0.398		2.067		4.271	

REVISIONS				JESSICA RENFROW, P.E. P.E. LICENSE NUMBER 80363 METRIC ENGINEERING, INC. 615 CRESCENT EXECUTIVE CT, SUITE 524 LAKE MARY, FLORIDA 32746 CERTIFICATE OF AUTHORIZATION: 2294	STATE OF FLORIDA DEPARTMENT OF TRANSPORTATION			TABULATION OF QUANTITIES	SHEET NO.
DATE	DESCRIPTION	DATE	DESCRIPTION		ROAD NO.	COUNTY	FINANCIAL PROJECT ID		
					400	SEMINOLE	439682-2-32-01		S-3

THE OFFICIAL RECORD OF THIS SHEET IS THE ELECTRONIC FILE DIGITALLY SIGNED AND SEALED UNDER RULE 61G15-23.004, F.A.C.

GENERAL NOTES

1. ALL REMOVED SIGNS AND THEIR SUPPORTS BECOME THE PROPERTY OF THE CONTRACTOR TO BE DISPOSED OF PROPERLY UNLESS OTHERWISE NOTED ON THE PLANS.
2. ALL EXISTING SIGNS ARE TO REMAIN UNLESS OTHERWISE NOTED ON THE PLANS.
3. ALL SPECIAL EMPHASIS CROSSWALKS SHALL BE 10 LF WIDE UNLESS OTHERWISE SHOWN ON THE PLANS.
4. IT IS THE CONTRACTOR'S RESPONSIBILITY TO REMOVE AND REPLACE ALL EXISTING SIGNS THAT CONFLICT WITH CONSTRUCTION OPERATIONS. IF SIGNS ARE DAMAGED BY THE CONTRACTOR, THE SIGNS SHALL BE REPLACED AT THE CONTRACTOR'S EXPENSE.
5. SIGN ASSEMBLY LOCATIONS SHOWN ON THE PLANS WHICH ARE IN CONFLICT WITH STREET LIGHTING, UTILITIES, ADA RAMPS, ETC. SHALL BE ADJUSTED SLIGHTLY AS DIRECTED BY THE ENGINEER. EXTREME LOCATION CHANGES MUST BE APPROVED BY THE ENGINEER.
6. THE CONTRACTOR SHALL APPLY THERMOPLASTIC AS THE FINAL PAVEMENT MARKINGS A MINIMUM OF THIRTY DAYS AFTER THE FIRST APPLICATION OF PAINT BUT PRIOR TO FINAL ACCEPTANCE OF THE PROJECT. ALL PAVEMENT MARKINGS SHALL BE INCLUDED IN THE COST OF THE PAY ITEM NUMBER.

REVISIONS				JESSICA RENFROW, P.E. P.E. LICENSE NUMBER 80363 METRIC ENGINEERING, INC. 615 CRESCENT EXECUTIVE CT, SUITE 524 LAKE MARY, FLORIDA 32746 CERTIFICATE OF AUTHORIZATION: 2294	STATE OF FLORIDA DEPARTMENT OF TRANSPORTATION			GENERAL NOTES	SHEET NO. S-4
DATE	DESCRIPTION	DATE	DESCRIPTION		ROAD NO.	COUNTY	FINANCIAL PROJECT ID		
					400	SEMINOLE	439682-2-32-01		

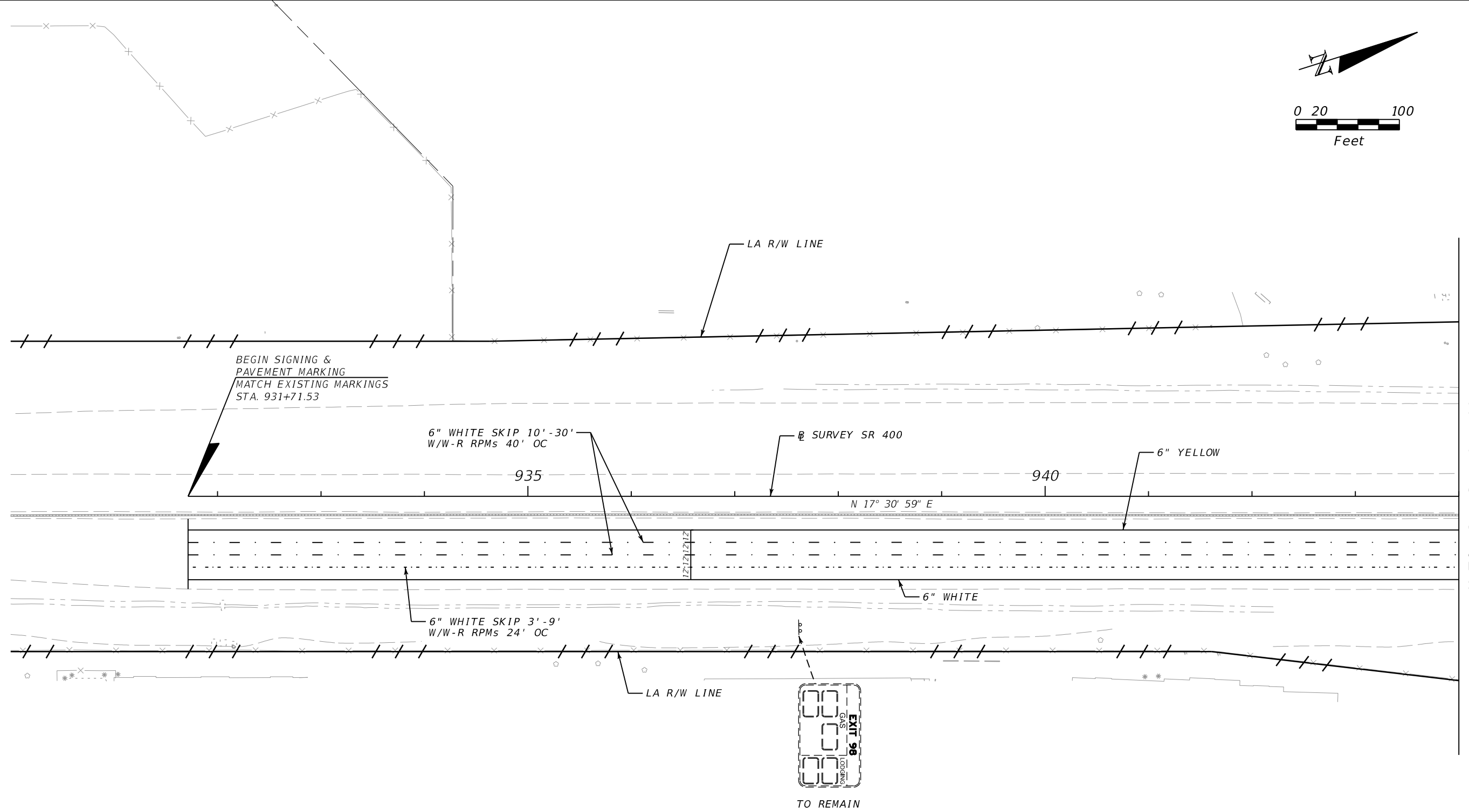
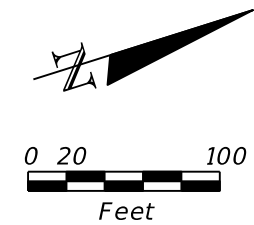

MATCHLINE STA. 944+00

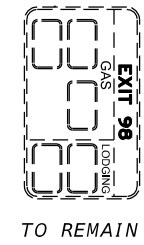

TO REMAIN

REVISIONS				JESSICA RENFROW, P.E. P.E. LICENSE NUMBER 80363 METRIC ENGINEERING, INC. 615 CRESCENT EXECUTIVE CT, SUITE 524 LAKE MARY, FLORIDA 32746 CERTIFICATE OF AUTHORIZATION: 2294	STATE OF FLORIDA DEPARTMENT OF TRANSPORTATION			SIGNING AND PAVEMENT MARKING SHEETS	SHEET NO. S-5
DATE	DESCRIPTION	DATE	DESCRIPTION		ROAD NO.	COUNTY	FINANCIAL PROJECT ID		
					400	SEMINOLE	439682-2-32-01		

THE OFFICIAL RECORD OF THIS SHEET IS THE ELECTRONIC FILE DIGITALLY SIGNED AND SEALED UNDER RULE 61G15-23.004, F.A.C.

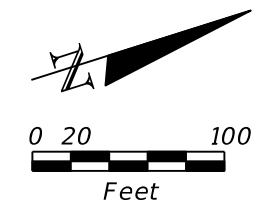

TO BE REMOVED

700-3-601	1 EA
700-3-603	1 EA
700-3-626	1 EA

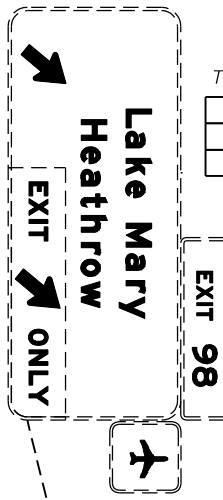

EXIT 98

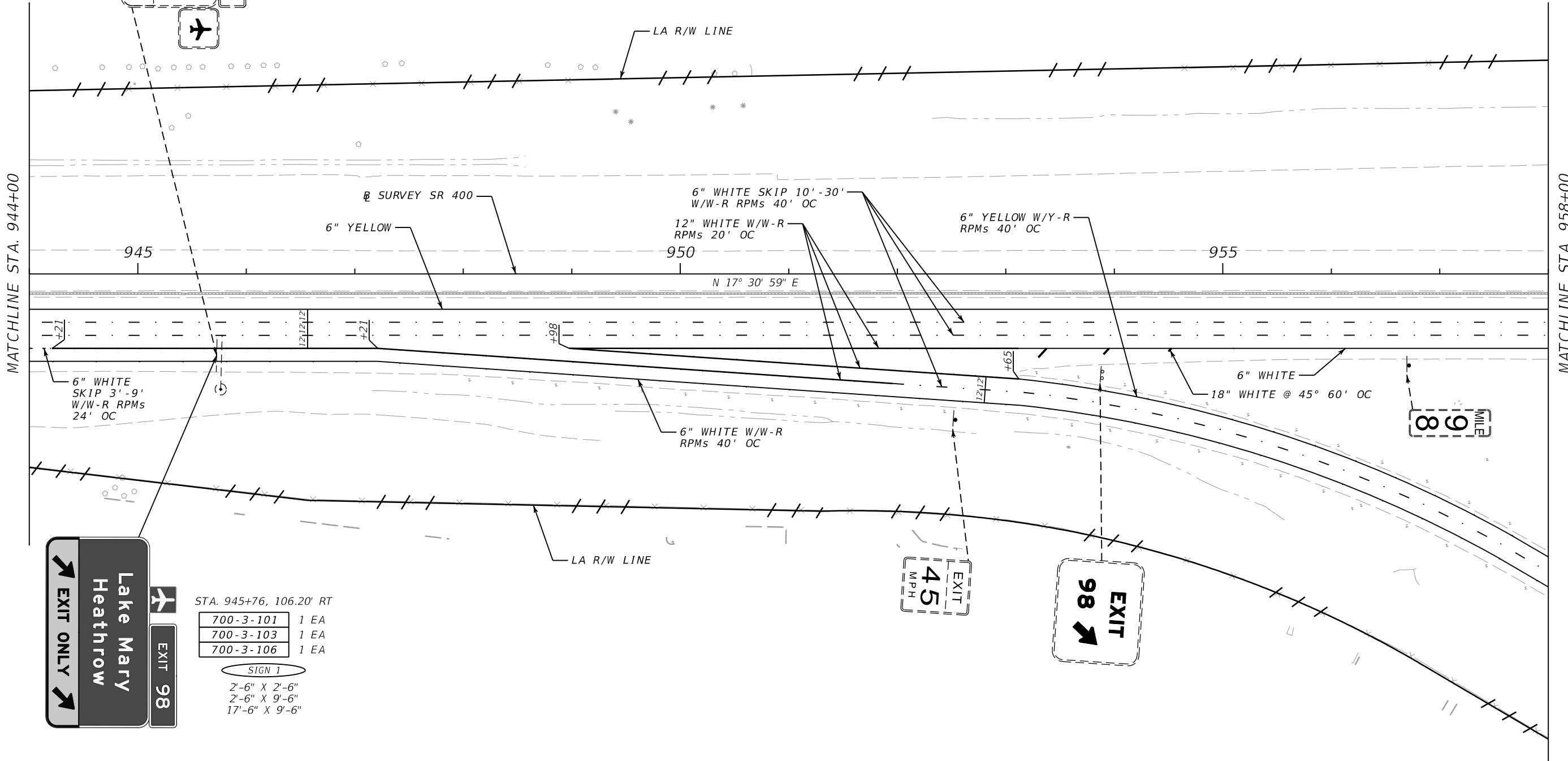

MATCHLINE STA. 944+00

MATCHLINE STA. 958+00

945

950

955

N 17° 30' 59" E

9 MILE

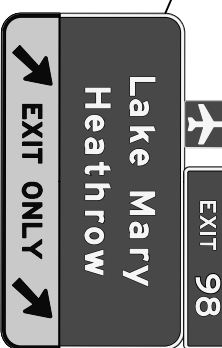

EXIT 98

STA. 945+76, 106.20' RT

700-3-101	1 EA
700-3-103	1 EA
700-3-106	1 EA

SIGN 1
 2'-6" X 2'-6"
 2'-6" X 9'-6"
 17'-6" X 9'-6"

EXIT 45 MPH

EXIT 98

REVISIONS				JESSICA RENFROW, P.E. P.E. LICENSE NUMBER 80363 METRIC ENGINEERING, INC. 615 CRESCENT EXECUTIVE CT, SUITE 524 LAKE MARY, FLORIDA 32746 CERTIFICATE OF AUTHORIZATION: 2294	STATE OF FLORIDA DEPARTMENT OF TRANSPORTATION			SIGNING AND PAVEMENT MARKING SHEETS	SHEET NO. S-6
DATE	DESCRIPTION	DATE	DESCRIPTION		ROAD NO.	COUNTY	FINANCIAL PROJECT ID		
					400	SEMINOLE	439682-2-32-01		

THE OFFICIAL RECORD OF THIS SHEET IS THE ELECTRONIC FILE DIGITALLY SIGNED AND SEALED UNDER RULE 61G15-23.004, F.A.C.

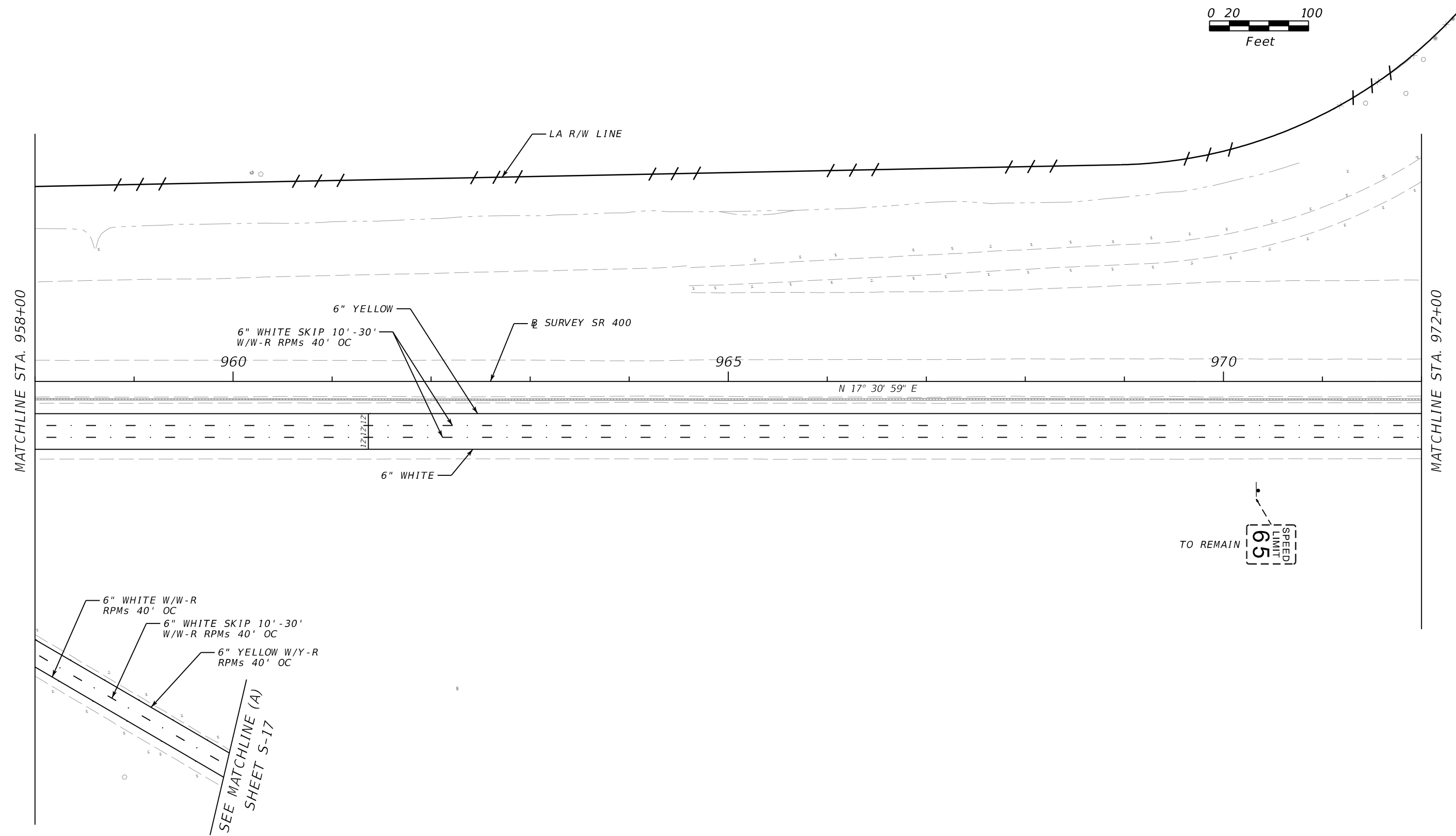
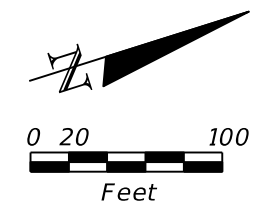

6" WHITE W/W-R
RPMs 40' OC

6" WHITE SKIP 10'-30'
W/W-R RPMs 40' OC

6" YELLOW W/Y-R
RPMs 40' OC

SEE MATCHLINE (A)
SHEET 5-17

REVISIONS				JESSICA RENFROW, P.E. P.E. LICENSE NUMBER 80363 METRIC ENGINEERING, INC. 615 CRESCENT EXECUTIVE CT, SUITE 524 LAKE MARY, FLORIDA 32746 CERTIFICATE OF AUTHORIZATION: 2294	STATE OF FLORIDA DEPARTMENT OF TRANSPORTATION			SIGNING AND PAVEMENT MARKING SHEETS	SHEET NO. S-7
DATE	DESCRIPTION	DATE	DESCRIPTION		ROAD NO.	COUNTY	FINANCIAL PROJECT ID		
				400	SEMINOLE	439682-2-32-01			

THE OFFICIAL RECORD OF THIS SHEET IS THE ELECTRONIC FILE DIGITALLY SIGNED AND SEALED UNDER RULE 61G15-23.004, F.A.C.

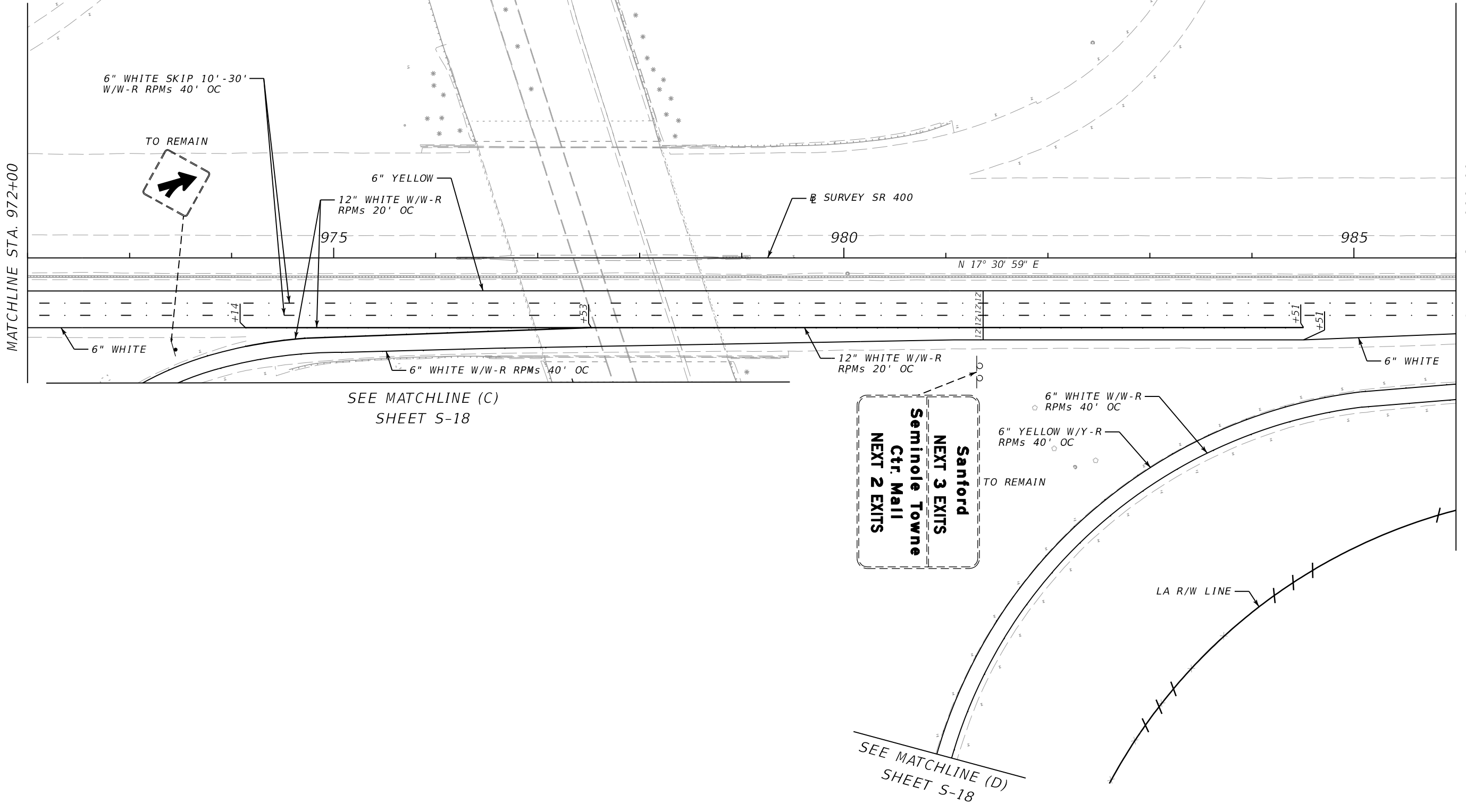
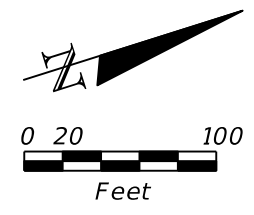

Sanford
NEXT 3 EXITS
Seminole Towne
Ctr. Mall
NEXT 2 EXITS

SEE MATCHLINE (C)
SHEET S-18

SEE MATCHLINE (D)
SHEET S-18

REVISIONS				JESSICA RENFROW, P.E. P.E. LICENSE NUMBER 80363 METRIC ENGINEERING, INC. 615 CRESCENT EXECUTIVE CT, SUITE 524 LAKE MARY, FLORIDA 32746 CERTIFICATE OF AUTHORIZATION: 2294	STATE OF FLORIDA DEPARTMENT OF TRANSPORTATION			SIGNING AND PAVEMENT MARKING SHEETS	SHEET NO. S-8
DATE	DESCRIPTION	DATE	DESCRIPTION		ROAD NO.	COUNTY	FINANCIAL PROJECT ID		
					400	SEMINOLE	439682-2-32-01		

THE OFFICIAL RECORD OF THIS SHEET IS THE ELECTRONIC FILE DIGITALLY SIGNED AND SEALED UNDER RULE 61G15-23.004, F.A.C.

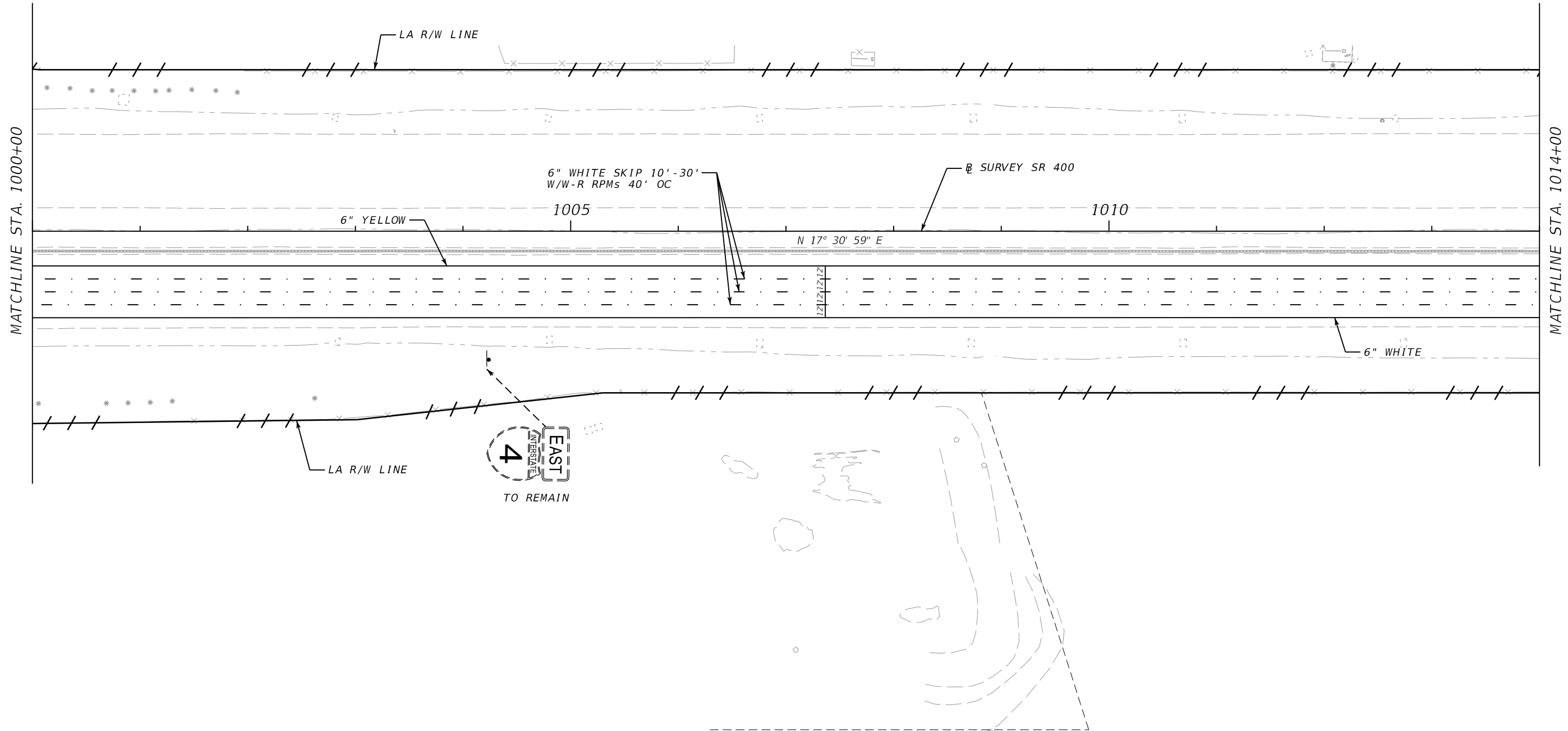
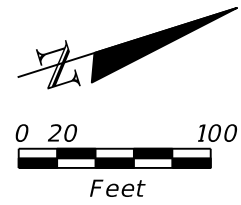

REVISIONS				JESSICA RENFROW, P.E. P.E. LICENSE NUMBER 80363 METRIC ENGINEERING, INC. 615 CRESCENT EXECUTIVE CT, SUITE 524 LAKE MARY, FLORIDA 32746 CERTIFICATE OF AUTHORIZATION: 2294	STATE OF FLORIDA DEPARTMENT OF TRANSPORTATION			SIGNING AND PAVEMENT MARKING SHEETS	SHEET NO. S-10
DATE	DESCRIPTION	DATE	DESCRIPTION		ROAD NO.	COUNTY	FINANCIAL PROJECT ID		
				400	SEMINOLE	439682-2-32-01			

THE OFFICIAL RECORD OF THIS SHEET IS THE ELECTRONIC FILE DIGITALLY SIGNED AND SEALED UNDER RULE 61G15-23.004, F.A.C.

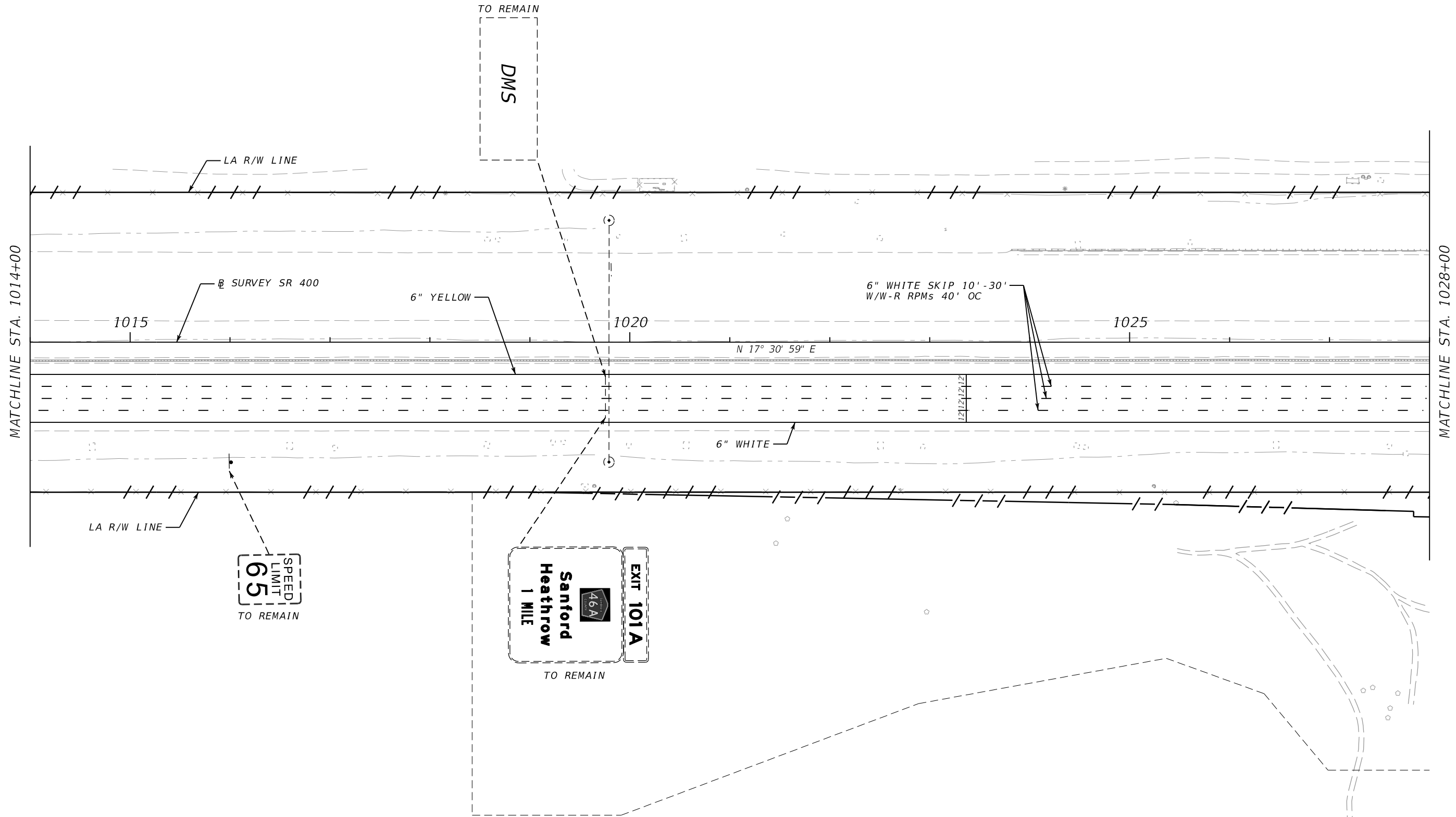
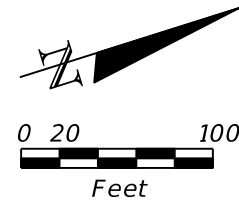

REVISIONS				JESSICA RENFROW, P.E. P.E. LICENSE NUMBER 80363 METRIC ENGINEERING, INC. 615 CRESCENT EXECUTIVE CT, SUITE 524 LAKE MARY, FLORIDA 32746 CERTIFICATE OF AUTHORIZATION: 2294	STATE OF FLORIDA DEPARTMENT OF TRANSPORTATION			SIGNING AND PAVEMENT MARKING SHEETS	SHEET NO.
DATE	DESCRIPTION	DATE	DESCRIPTION		ROAD NO.	COUNTY	FINANCIAL PROJECT ID		
					400	SEMINOLE	439682-2-32-01		5-11

THE OFFICIAL RECORD OF THIS SHEET IS THE ELECTRONIC FILE DIGITALLY SIGNED AND SEALED UNDER RULE 61G15-23.004, F.A.C.

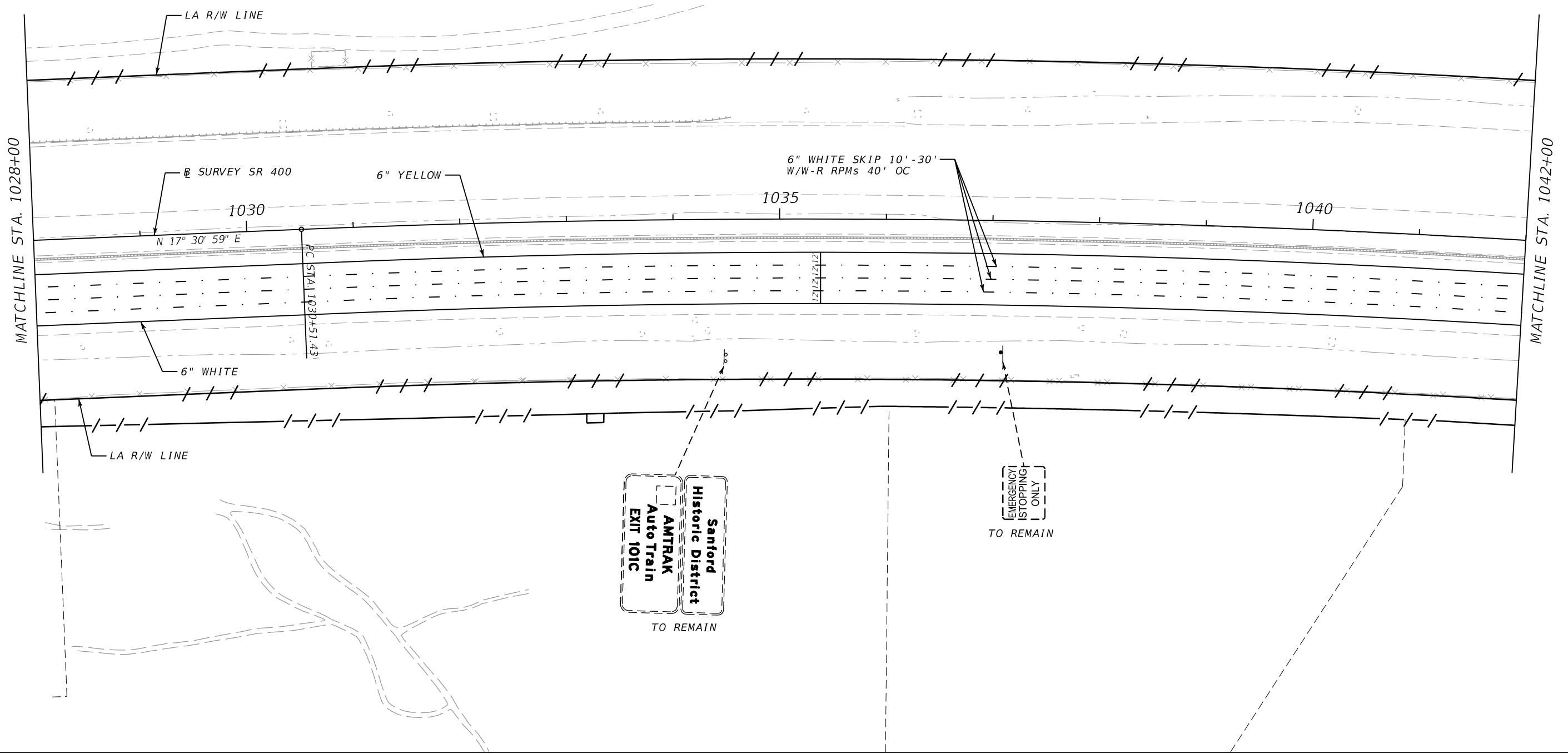
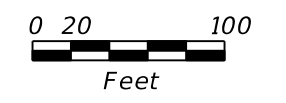

JESSICA RENFROW, P.E.
 P.E. LICENSE NUMBER 80363
 METRIC ENGINEERING, INC.
 615 CRESCENT EXECUTIVE CT, SUITE 524
 LAKE MARY, FLORIDA 32746
 CERTIFICATE OF AUTHORIZATION: 2294

STATE OF FLORIDA DEPARTMENT OF TRANSPORTATION		
ROAD NO.	COUNTY	FINANCIAL PROJECT ID
400	SEMINOLE	439682-2-32-01

**SIGNING AND PAVEMENT
MARKING SHEETS**

REVISIONS			
DATE	DESCRIPTION	DATE	DESCRIPTION

SHEET NO.
5-12

THE OFFICIAL RECORD OF THIS SHEET IS THE ELECTRONIC FILE DIGITALLY SIGNED AND SEALED UNDER RULE 61G15-23.004, F.A.C.

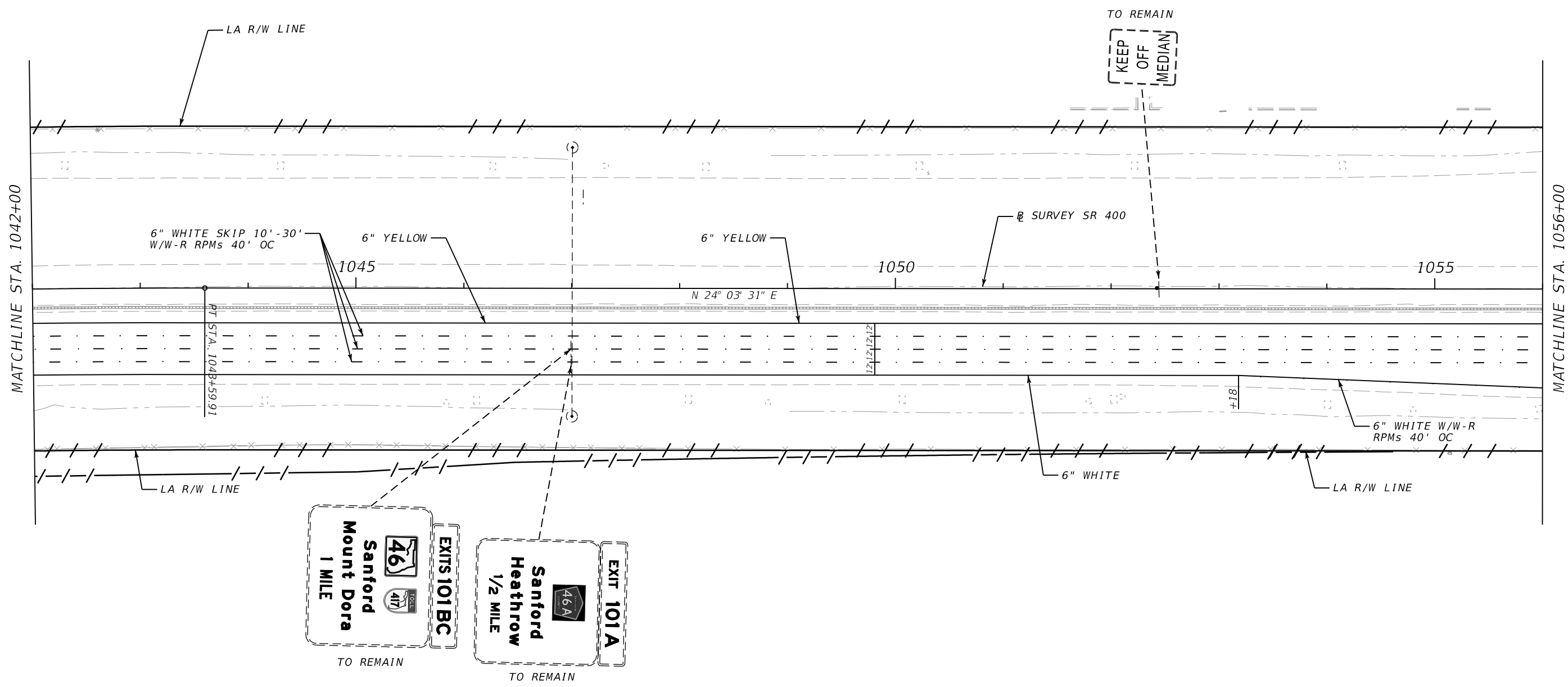
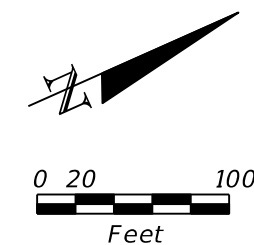

REVISIONS				JESSICA RENFROW, P.E. P.E. LICENSE NUMBER 80363 METRIC ENGINEERING, INC. 615 CRESCENT EXECUTIVE CT, SUITE 524 LAKE MARY, FLORIDA 32746 CERTIFICATE OF AUTHORIZATION: 2294	STATE OF FLORIDA DEPARTMENT OF TRANSPORTATION			SIGNING AND PAVEMENT MARKING SHEETS	SHEET NO. 5-13
DATE	DESCRIPTION	DATE	DESCRIPTION		ROAD NO.	COUNTY	FINANCIAL PROJECT ID		
					400	SEMINOLE	439682-2-32-01		

THE OFFICIAL RECORD OF THIS SHEET IS THE ELECTRONIC FILE DIGITALLY SIGNED AND SEALED UNDER RULE 61G15-23.004, F.A.C.

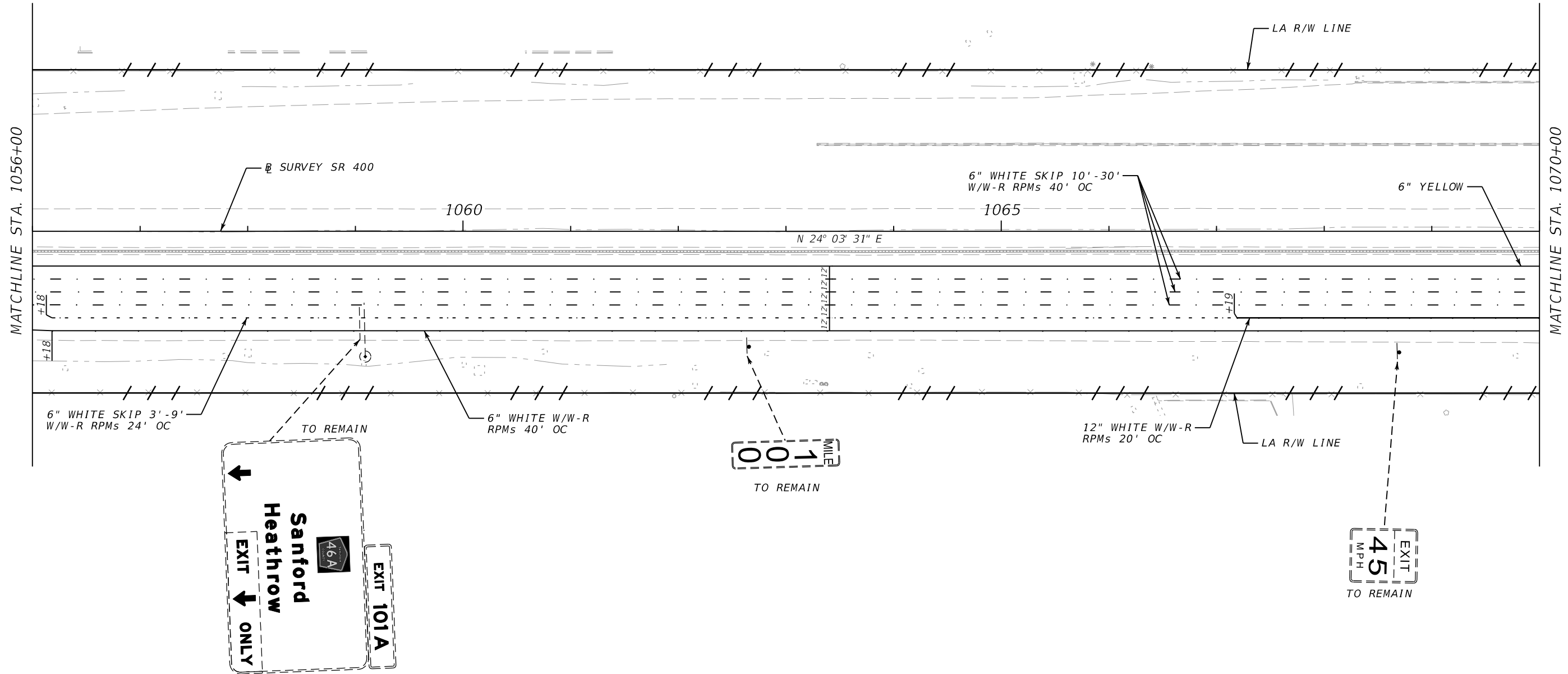
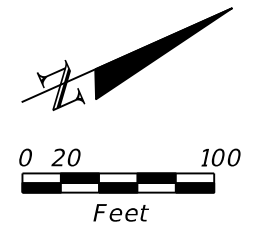

REVISIONS				JESSICA RENFROW, P.E. P.E. LICENSE NUMBER 80363 METRIC ENGINEERING, INC. 615 CRESCENT EXECUTIVE CT, SUITE 524 LAKE MARY, FLORIDA 32746 CERTIFICATE OF AUTHORIZATION: 2294	STATE OF FLORIDA DEPARTMENT OF TRANSPORTATION			SIGNING AND PAVEMENT MARKING SHEETS	SHEET NO.
DATE	DESCRIPTION	DATE	DESCRIPTION		ROAD NO.	COUNTY	FINANCIAL PROJECT ID		
					400	SEMINOLE	439682-2-32-01		5-14

THE OFFICIAL RECORD OF THIS SHEET IS THE ELECTRONIC FILE DIGITALLY SIGNED AND SEALED UNDER RULE 61G15-23.004, F.A.C.

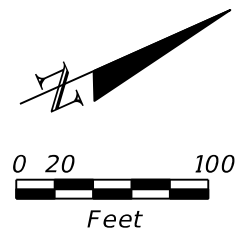

TO REMAIN

Sanford
Mount Dora
1/2 MILE

46

417

H EXITS 101BC

TO REMAIN

SPEED LIMIT **65**

MATCHLINE STA. 1070+00

MATCHLINE STA. 1084+00

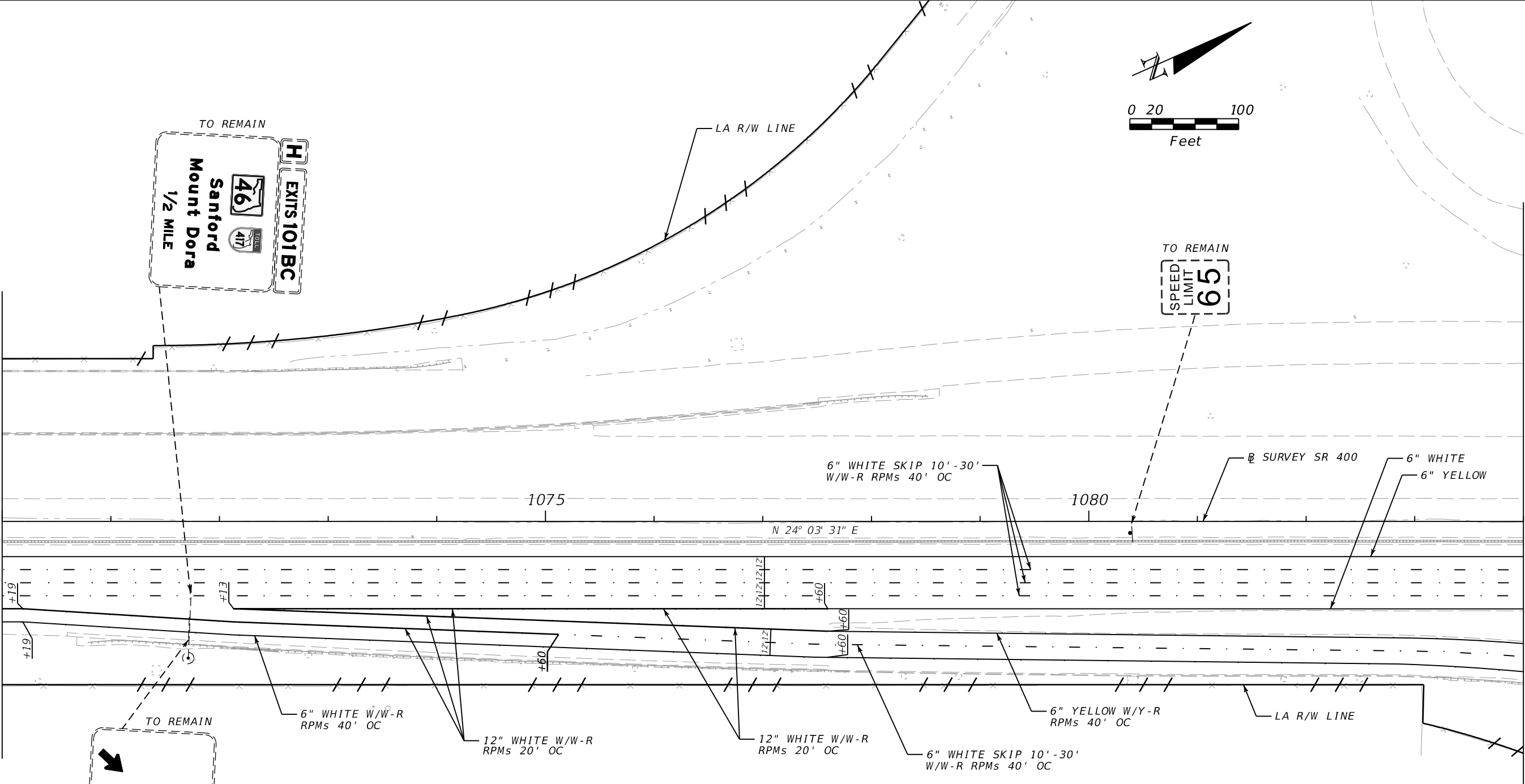

TO REMAIN

Sanford
Heathrow

46A

EXIT ONLY

EXIT 101A

REVISIONS				JESSICA RENFROW, P.E. P.E. LICENSE NUMBER 80363 METRIC ENGINEERING, INC. 615 CRESCENT EXECUTIVE CT, SUITE 524 LAKE MARY, FLORIDA 32746 CERTIFICATE OF AUTHORIZATION: 2294	STATE OF FLORIDA DEPARTMENT OF TRANSPORTATION			SIGNING AND PAVEMENT MARKING SHEETS	SHEET NO.
DATE	DESCRIPTION	DATE	DESCRIPTION		ROAD NO.	COUNTY	FINANCIAL PROJECT ID		
						400	SEMINOLE		439682-2-32-01

THE OFFICIAL RECORD OF THIS SHEET IS THE ELECTRONIC FILE DIGITALLY SIGNED AND SEALED UNDER RULE 61G15-23.004, F.A.C.

NOTES TO REVIEWER:
 ## BASELINE WILL BE CREATED AT 90% SUBMITTAL.

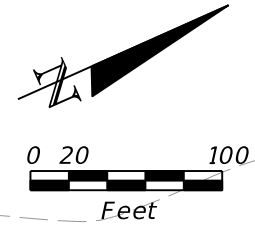

MATCHLINE STA. 1084+00

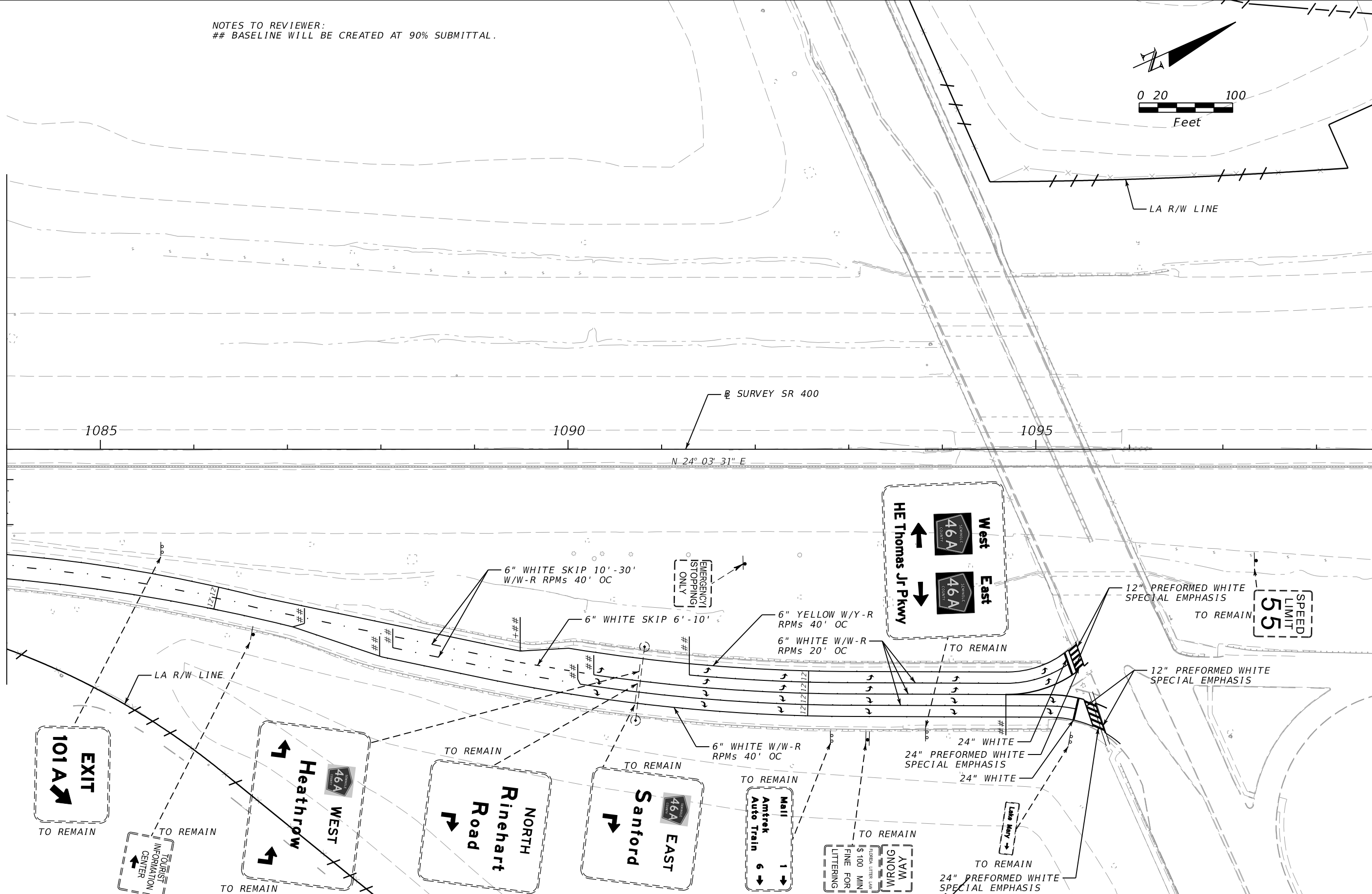

REVISIONS		REVISIONS	
DATE	DESCRIPTION	DATE	DESCRIPTION

JESSICA RENFROW, P.E.
 P.E. LICENSE NUMBER 80363
 METRIC ENGINEERING, INC.
 615 CRESCENT EXECUTIVE CT, SUITE 524
 LAKE MARY, FLORIDA 32746
 CERTIFICATE OF AUTHORIZATION: 2294

STATE OF FLORIDA DEPARTMENT OF TRANSPORTATION		
ROAD NO.	COUNTY	FINANCIAL PROJECT ID
400	SEMINOLE	439682-2-32-01

**SIGNING AND PAVEMENT
MARKING SHEETS**

SHEET
NO.
5-16

THE OFFICIAL RECORD OF THIS SHEET IS THE ELECTRONIC FILE DIGITALLY SIGNED AND SEALED UNDER RULE 61G15-23.004, F.A.C.

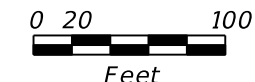
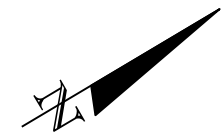

SEE MATCHLINE (A) SHEET S-7

SEE MATCHLINE (B) SHEET S-18

6" WHITE W/W-R
RPMs 40' OC

6" YELLOW W/Y-R
RPMs 40' OC

6" WHITE SKIP 10'-30'
W/W-R RPMs 40' OC

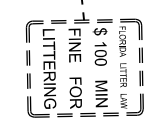

TO REMAIN

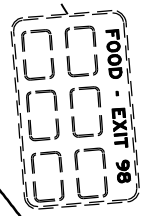

TO REMAIN



TO REMAIN

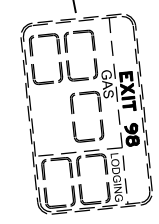

TO REMAIN

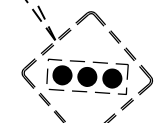

TO REMAIN

REVISIONS			
DATE	DESCRIPTION	DATE	DESCRIPTION

JESSICA RENFROW, P.E.
P.E. LICENSE NUMBER 80363
METRIC ENGINEERING, INC.
615 CRESCENT EXECUTIVE CT, SUITE 524
LAKE MARY, FLORIDA 32746
CERTIFICATE OF AUTHORIZATION: 2294

STATE OF FLORIDA DEPARTMENT OF TRANSPORTATION		
ROAD NO.	COUNTY	FINANCIAL PROJECT ID
400	SEMINOLE	439682-2-32-01

**SIGNING AND PAVEMENT
MARKING SHEETS**

SHEET NO.
S-17

THE OFFICIAL RECORD OF THIS SHEET IS THE ELECTRONIC FILE DIGITALLY SIGNED AND SEALED UNDER RULE 61G15-23.004, F.A.C.

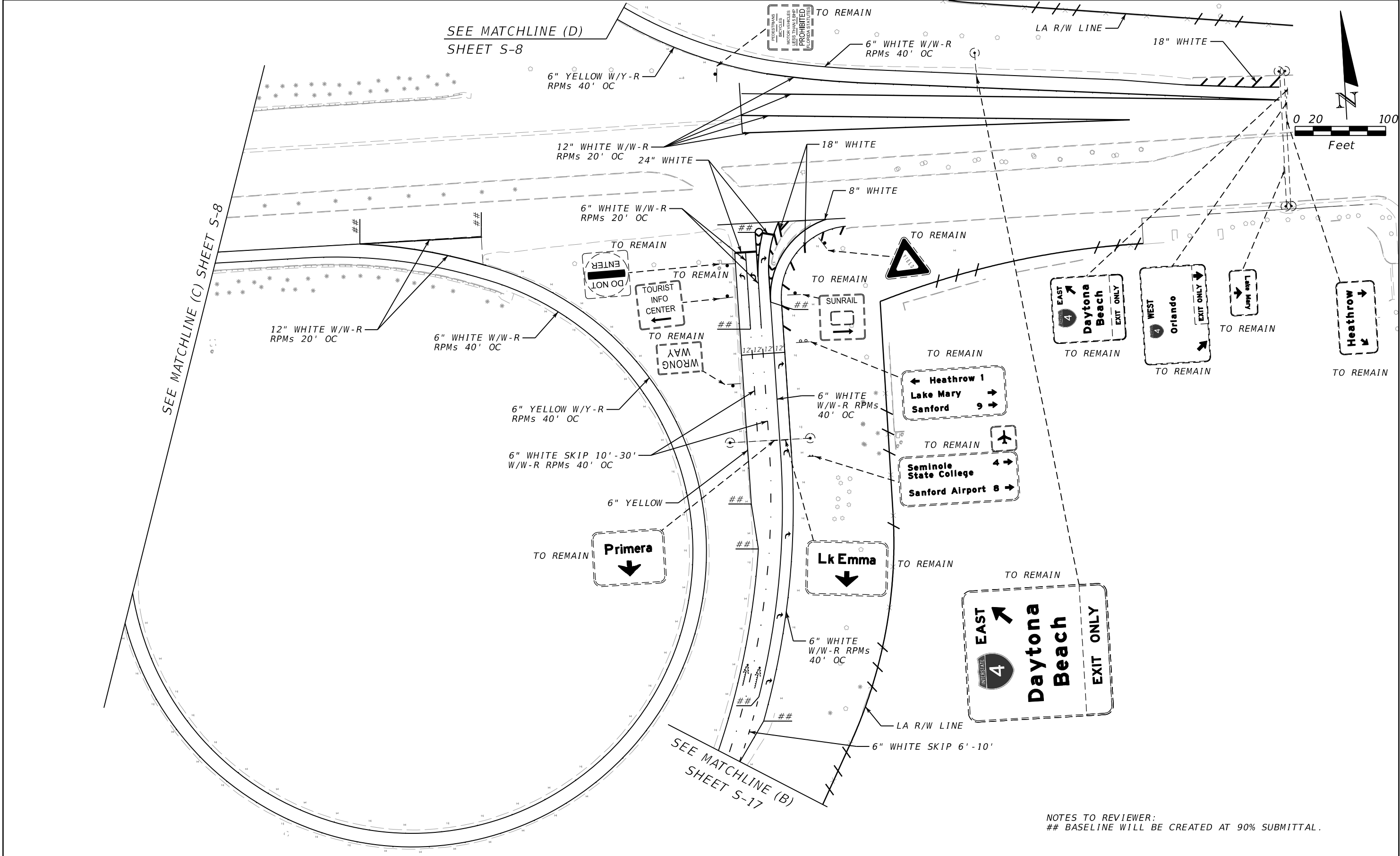

NOTES TO REVIEWER:
 ## BASELINE WILL BE CREATED AT 90% SUBMITTAL.

REVISIONS				JESSICA RENFROW, P.E. P.E. LICENSE NUMBER 80363 METRIC ENGINEERING, INC. 615 CRESCENT EXECUTIVE CT, SUITE 524 LAKE MARY, FLORIDA 32746 CERTIFICATE OF AUTHORIZATION: 2294	STATE OF FLORIDA DEPARTMENT OF TRANSPORTATION			SIGNING AND PAVEMENT MARKING SHEETS	SHEET NO. S-18
DATE	DESCRIPTION	DATE	DESCRIPTION		ROAD NO.	COUNTY	FINANCIAL PROJECT ID		
				400	SEMINOLE	439682-2-32-01			

THE OFFICIAL RECORD OF THIS SHEET IS THE ELECTRONIC FILE DIGITALLY SIGNED AND SEALED UNDER RULE 61G15-23.004, F.A.C.

SIGN NAME	1	QTY	1	SIGN NO.		STATION(S)	
PANEL		BORDER				945+76	
WIDTH	17'-6"	WIDTH	2"				
HEIGHT	9'-6"	RADII	12"				
LEGEND	White/Black	COLOR	White				
COLOR	Green						
SYMBOL(S)		ANGLE	X	Y	WID	HT	
		0	10.8	130.8	22.4	20	
		0	0.5	119.6	32	20	
		0	0	0	30	30	
		0	0	0	22.4	20	
AR_Type A	315	19.9	6.6	20	20	31.5	
AR_Type A	315	165.3	6.6	20	20	31.5	
SIGN NO.	NO. OF POSTS	EDGE OF LANE CLEARANCE	COLUMN SIZE	AVERAGE LENGTH			

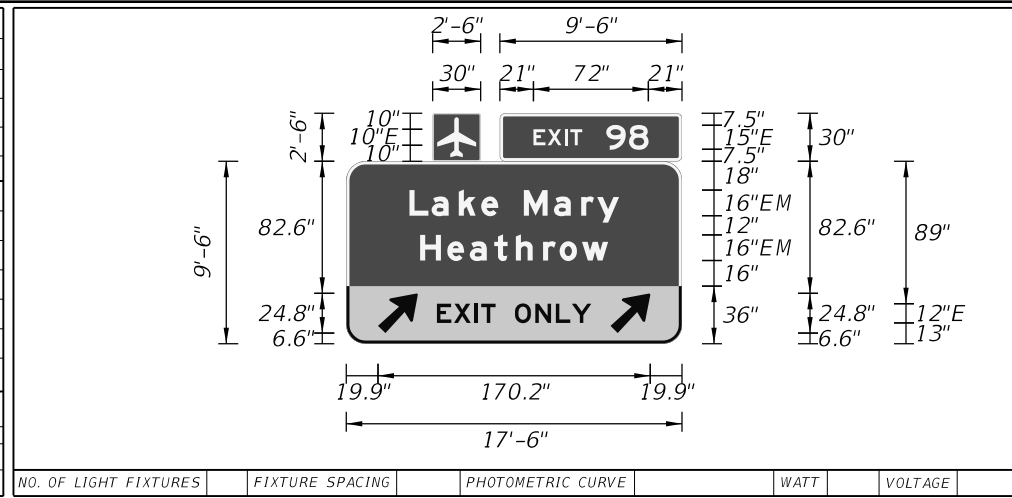

NO. OF LIGHT FIXTURES	FIXTURE SPACING	PHOTOMETRIC CURVE	WATT	VOLTAGE
-----------------------	-----------------	-------------------	------	---------

COPY		E	X	I	T		9	8	L			
SPACE	21	8.9	10.7	3.5	7.5	15	14.3	12.2	21	72		
COPY		L	a	k	e		M	a	r	y	L	
SPACE	39.5	13.9	17	14.1	10.6	16	18.9	17	10.1	13.6	39.5	131
COPY		H	e	a	t	h	r	o	w	L		
SPACE	46.2	17	14.1	15.4	13.4	17	10.4	14.1	16.3	46.2	117.6	
COPY		E	X	I	T		O	N	L	Y	L	
SPACE	56.7	10.7	12.8	4.2	9	12	12.8	12.8	10	12.2	56.7	96.6
COPY												
SPACE												
COPY												
SPACE												

NO. OF LIGHT FIXTURES	FIXTURE SPACING	PHOTOMETRIC CURVE	WATT	VOLTAGE
-----------------------	-----------------	-------------------	------	---------

SIGN NAME		QTY		SIGN NO.		STATION(S)	
PANEL		BORDER					
WIDTH		WIDTH					
HEIGHT		RADII					
LEGEND		COLOR					
COLOR							
SYMBOL(S)		ANGLE	X	Y	WID	HT	
SIGN NO.	NO. OF POSTS	EDGE OF LANE CLEARANCE	COLUMN SIZE	AVERAGE LENGTH			

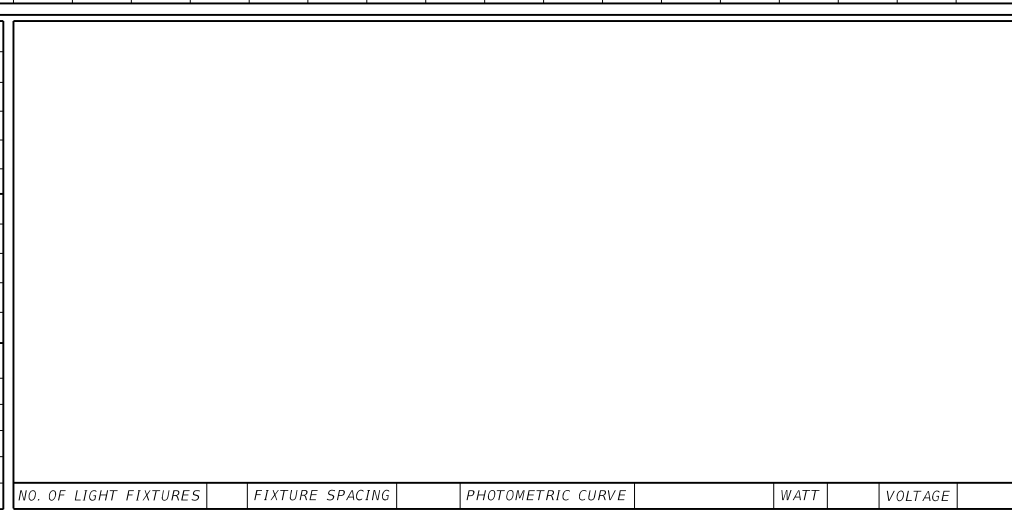

NO. OF LIGHT FIXTURES	FIXTURE SPACING	PHOTOMETRIC CURVE	WATT	VOLTAGE
-----------------------	-----------------	-------------------	------	---------

COPY												
SPACE												
COPY												
SPACE												
COPY												
SPACE												
COPY												
SPACE												
COPY												
SPACE												

NO. OF LIGHT FIXTURES	FIXTURE SPACING	PHOTOMETRIC CURVE	WATT	VOLTAGE
-----------------------	-----------------	-------------------	------	---------

SIGN NAME		QTY		SIGN NO.		STATION(S)	
PANEL		BORDER					
WIDTH		WIDTH					
HEIGHT		RADII					
LEGEND		COLOR					
COLOR							
SYMBOL(S)		ANGLE	X	Y	WID	HT	
SIGN NO.	NO. OF POSTS	EDGE OF LANE CLEARANCE	COLUMN SIZE	AVERAGE LENGTH			

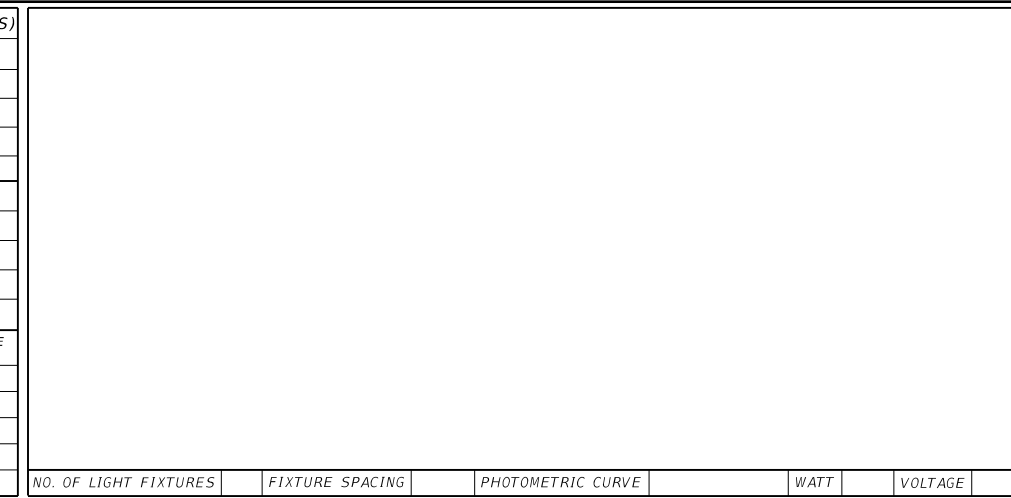

NO. OF LIGHT FIXTURES	FIXTURE SPACING	PHOTOMETRIC CURVE	WATT	VOLTAGE
-----------------------	-----------------	-------------------	------	---------

COPY												
SPACE												
COPY												
SPACE												
COPY												
SPACE												
COPY												
SPACE												
COPY												
SPACE												

NO. OF LIGHT FIXTURES	FIXTURE SPACING	PHOTOMETRIC CURVE	WATT	VOLTAGE
-----------------------	-----------------	-------------------	------	---------

SIGN NAME		QTY		SIGN NO.		STATION(S)	
PANEL		BORDER					
WIDTH		WIDTH					
HEIGHT		RADII					
LEGEND		COLOR					
COLOR							
SYMBOL(S)		ANGLE	X	Y	WID	HT	
SIGN NO.	NO. OF POSTS	EDGE OF LANE CLEARANCE	COLUMN SIZE	AVERAGE LENGTH			

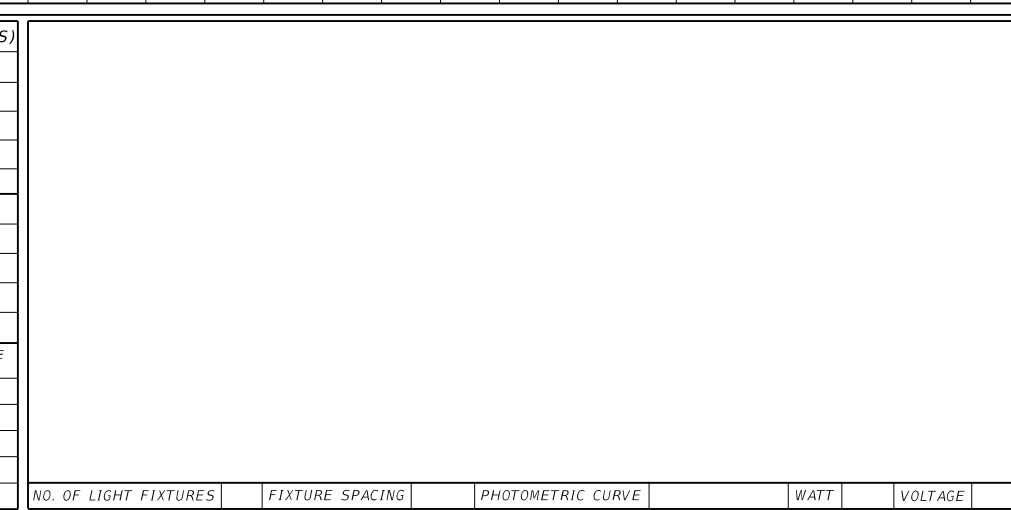

NO. OF LIGHT FIXTURES	FIXTURE SPACING	PHOTOMETRIC CURVE	WATT	VOLTAGE
-----------------------	-----------------	-------------------	------	---------

COPY												
SPACE												
COPY												
SPACE												
COPY												
SPACE												
COPY												
SPACE												
COPY												
SPACE												

NO. OF LIGHT FIXTURES	FIXTURE SPACING	PHOTOMETRIC CURVE	WATT	VOLTAGE
-----------------------	-----------------	-------------------	------	---------

REVISIONS			
DATE	DESCRIPTION	DATE	DESCRIPTION

JESSICA RENFROW, P.E.
P.E. LICENSE NUMBER 80363
METRIC ENGINEERING, INC.
615 CRESCENT EXECUTIVE CT, SUITE 524
LAKE MARY, FLORIDA 32746
CERTIFICATE OF AUTHORIZATION: 2294

STATE OF FLORIDA DEPARTMENT OF TRANSPORTATION		
ROAD NO.	COUNTY	FINANCIAL PROJECT ID
400	SEMINOLE	439682-2-32-01

GUIDE SIGN WORKSHEET

SHEET NO.
S-19

THE OFFICIAL RECORD OF THIS SHEET IS THE ELECTRONIC FILE DIGITALLY SIGNED AND SEALED UNDER RULE 61G15-23.004, F.A.C.