

STATE OF FLORIDA
DEPARTMENT OF TRANSPORTATION

SIGNING AND PAVEMENT MARKING PLANS

INDEX OF SIGNING AND PAVEMENT MARKING PLANS

SHEET NO.	SHEET DESCRIPTION
S-1	KEY SHEET
S-2	TABULATION OF QUANTITIES
S-3	GENERAL NOTES
S-4 - S-6	PLAN SHEETS

FINANCIAL PROJECT ID 439682-4-52-01
SEMINOLE COUNTY (77160)

EE WILLIAMSON RD. BRIDGE REPLACEMENT OVER STATE ROAD NO. 400 (I-4)
FROM SUNSHINE TREE BLVD.
TO EAST OF PENELOPE DR.

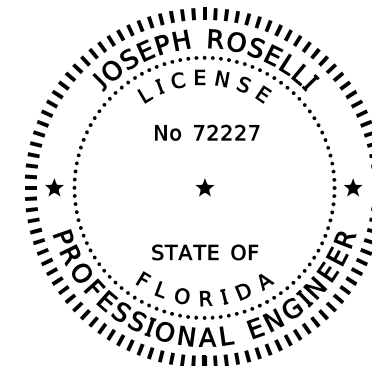
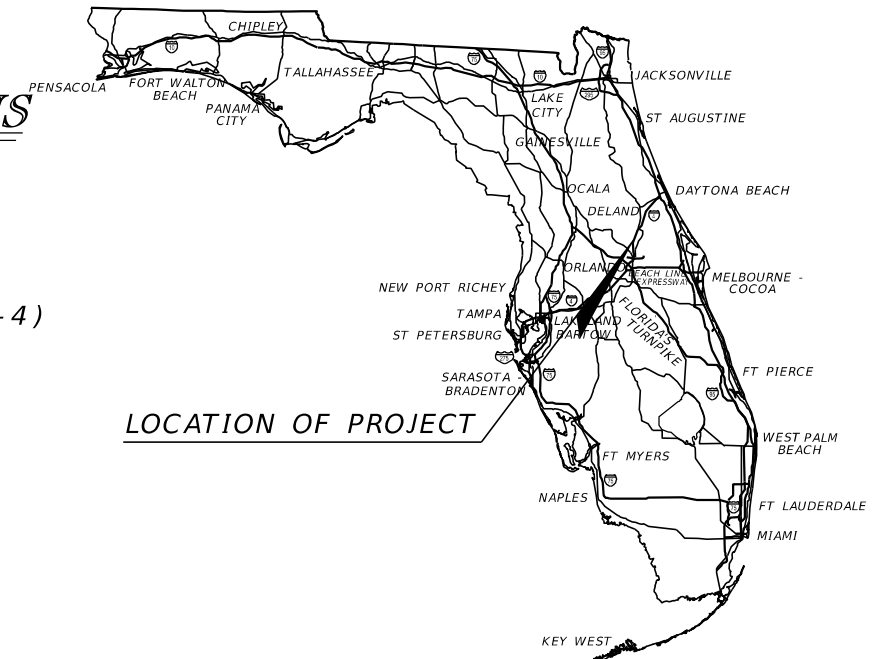

THIS DOCUMENT HAS BEEN DIGITALLY SIGNED AND SEALED BY:

PRINTED COPIES OF THIS DOCUMENT ARE NOT CONSIDERED SIGNED AND SEALED. THE SIGNATURE MUST BE VERIFIED ON THE ELECTRONIC DOCUMENTS.

SIGNING & PAVEMENT MARKING ENGINEER OF RECORD:

JOSEPH ROSELLI, P.E.
P.E. NO.: 72227
HORIZON ENGINEERING GROUP, INC.
2603 Maitland Center Pkwy., Suite B
Maitland, FL 32751
Phone: 407-644-7755
FAX: 407-644-7855
Contract No. : C9U03
Vendor No.:43-1994849
Certificate of Authorization No.: 00009544

FDOT PROJECT MANAGER:

HATEM AQUIB, PE

PHASE II PLANS
7/16/2018

CONSTRUCTION CONTRACT NO.	FISCAL YEAR	SHEET NO.
	19	S-1

THE OFFICIAL RECORD OF THIS SHEET IS THE ELECTRONIC FILE DIGITALLY SIGNED AND SEALED UNDER RULE 61G15-23.004, F.A.C.

TABULATION OF QUANTITIES

PAY ITEM NO.	DESCRIPTION	UNIT	SHEET NUMBERS												TOTAL THIS SHEET		GRAND TOTAL			
			S-4		S-5		S-6										PLAN	FINAL	PLAN	FINAL
			PLAN	FINAL	PLAN	FINAL	PLAN	FINAL												
700-1-11	SINGLE POST SIGN, F&I GROUND MOUNT, UP TO 12 SF	AS																		
700-1-50	SINGLE POST SIGN, RELOCATE	AS																		
700-3-101	SIGN PANEL, F&I GROUND MOUNT, UP TO 12 SF	EA																		
710-90	PAINTED PAVEMENT MARKINGS, FINAL SURFACE	LS																		
*	RETRO-REFLECTIVE PAVEMENT MARKER (W/R)	EA																		
*	RETRO-REFLECTIVE PAVEMENT MARKER (Y/Y)	EA																		
*	PAINTED PAVEMENT MARKINGS, STANDARD, WHITE, SOLID, 6"	GM																		
*	PAINTED PAVEMENT MARKINGS, STANDARD, WHITE, SOLID, 8"	GM																		
*	PAINTED PAVEMENT MARKINGS, STANDARD, WHITE, SOLID, 18" FOR DIAGONALS AND CHEVRONS	LF																		
*	PAINTED PAVEMENT MARKINGS, STANDARD, WHITE, SOLID, 24" FOR STOP LINE AND CROSSWALK	LF																		
*	PAINTED PAVEMENT MARKINGS, STANDARD, WHITE, SKIP, 10-30 SKIP, 6"	GM																		
*	PAINTED PAVEMENT MARKINGS, STANDARD, WHITE, 6-10 DOTTED EXTENSION LINE, 6"	GM																		
*	PAINTED PAVEMENT MARKINGS, STANDARD, WHITE, 2-4 DOTTED GUIDELINE, 6"	GM																		
*	PAINTED PAVEMENT MARKINGS, STANDARD, WHITE, MESSAGE	EA																		
*	TRAIL																			
*	XING																			
*	BIKE SYMBOL																			
*	PAINTED PAVEMENT MARKINGS, STANDARD, WHITE, ARROW	EA																		
*	LEFT																			
*	RIGHT																			
*	BIKE THRU																			
*	PAINTED PAVEMENT MARKINGS, STANDARD, YELLOW, SOLID, 6"	GM																		
*	PAINTED PAVEMENT MARKINGS, STANDARD, YELLOW, SOLID, 18" FOR DIAGONAL OR CHEVRON	LF																		
711-11-124	THERMOPLASTIC, STANDARD, WHITE, SOLID, 18" FOR DIAGONALS AND CHEVRONS	LF																		
711-11-125	THERMOPLASTIC, STANDARD, WHITE, SOLID, 24" FOR STOP LINE	LF																		
711-11-141	THERMOPLASTIC, STANDARD, WHITE, 2'-4' DOTTED GUIDE LINE, 6"	GM																		
711-11-170	THERMOPLASTIC, STANDARD, WHITE, ARROWS	EA																		
	LEFT																			
	RIGHT																			
711-11-224	THERMOPLASTIC, STANDARD, YELLOW, SOLID, 18" FOR DIAGONAL OR CHEVRON	LF																		
711-14-123	THERMOPLASTIC, PREFORMED, WHITE, SOLID, 12" FOR CROSSWALK	LF																		
711-14-125	THERMOPLASTIC, PREFORMED, WHITE, SOLID, 24" FOR CROSSWALK	LF																		
711-14-160	THERMOPLASTIC, PREFORMED, WHITE, MESSAGE "BICYCLE PERSON"	EA																		
711-14-170	THERMOPLASTIC, PREFORMED, WHITE, ARROW "BICYCLE"	EA																		
711-16-101	THERMOPLASTIC, STANDARD-OTHER SURFACES, WHITE, SOLID, 6"	GM																		
711-16-102	THERMOPLASTIC, STANDARD-OTHER SURFACES, WHITE, SOLID, 8"	GM																		
711-16-131	THERMOPLASTIC, STANDARD-OTHER SURFACES, WHITE, SKIP, 6", 10' - 30' SKIP	GM																		
711-16-201	THERMOPLASTIC, STANDARD-OTHER SURFACES, YELLOW, SOLID, 6"	GM																		
713-103-101	PERMANENT TAPE, WHITE, SOLID, 6" FOR CONCRETE BRIDGES	GM																		
713-103-201	PERMANENT TAPE, YELLOW, SOLID, 6" FOR CONCRETE BRIDGES	GM																		

* NOTE: THESE QUANTITIES ARE PAID FOR UNDER PAINTED PAVEMENT MARKINGS (FINAL SURFACE), LUMP SUM- ITEM NO. 710-90. THESE QUANTITIES ARE FOR ONE APPLICATION; SEE SPECIFICATION 710 FOR THE NUMBER OF APPLICATIONS REQUIRED.

<table border="1"> <thead> <tr> <th colspan="4">REVISIONS</th> </tr> <tr> <th>DATE</th> <th>DESCRIPTION</th> <th>DATE</th> <th>DESCRIPTION</th> </tr> </thead> <tbody> <tr> <td> </td> <td> </td> <td> </td> <td> </td> </tr> </tbody> </table>				REVISIONS				DATE	DESCRIPTION	DATE	DESCRIPTION					HORIZON ENGINEERING GROUP, INC. 2603 Maitland Center Pkwy., Suite B Maitland, Florida 32751 Phone: 407-644-7755 Certificate of Authorization No.: 00009544 JOSEPH ROSELLI, P.E. NO. 72227			STATE OF FLORIDA DEPARTMENT OF TRANSPORTATION			ROAD NO. COUNTY FINANCIAL PROJECT ID SEMINOLE 439682-4-52-01		TABULATION OF QUANTITIES				SHEET NO. S-2	
REVISIONS																													
DATE	DESCRIPTION	DATE	DESCRIPTION																										

THE OFFICIAL RECORD OF THIS SHEET IS THE ELECTRONIC FILE DIGITALLY SIGNED AND SEALED UNDER RULE 61G15-23.004, F.A.C.

SIGNING AND PAVEMENT MARKING GENERAL NOTES

1. MATCH EXISTING PAVEMENT MARKINGS AT THE BEGINING AND END OF THE PROJECT AND AT ALL SIDE STREETS.
2. ALL EXISTING SIGNS ARE TO REMAIN UNLESS OTHERWISE NOTED.
3. CROSSWALKS SHALL BE CENTERED ON THE EXISTING OR PROPOSED CURB RAMPS.

LEGEND FOR SIGNING AND PAVEMENT MARKING DESCRIPTIONS

W/R - WHITE-RED
Y/Y - YELLOW-YELLOW

REVISIONS				HORIZON ENGINEERING GROUP, INC. 2603 Maitland Center Pkwy., Suite B Maitland, Florida 32751 Phone: 407-644-7755 Certificate of Authorization No.: 00009544 JOSEPH ROSELLI, P.E. NO. 72227	STATE OF FLORIDA DEPARTMENT OF TRANSPORTATION			GENERAL NOTES	SHEET NO.
DATE	DESCRIPTION	DATE	DESCRIPTION		ROAD NO.	COUNTY	FINANCIAL PROJECT ID		S-3
					SEMINOLE	439682-4-52-01			

THE OFFICIAL RECORD OF THIS SHEET IS THE ELECTRONIC FILE DIGITALLY SIGNED AND SEALED UNDER RULE 61G15-23.004, F.A.C.

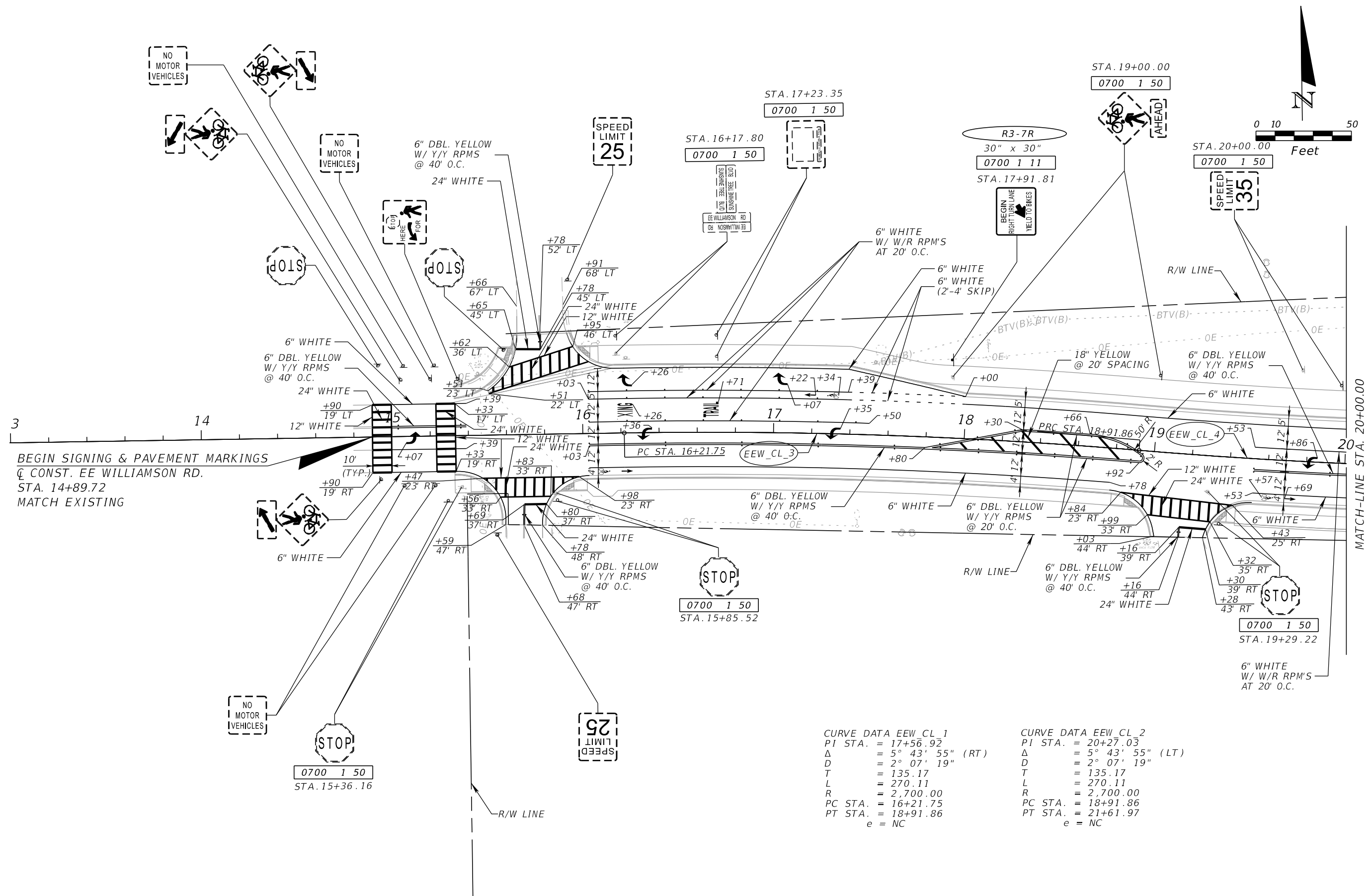

BEGIN SIGNING & PAVEMENT MARKINGS
 Q CONST. EE WILLIAMSON RD.
 STA. 14+89.72
 MATCH EXISTING

CURVE DATA EEW_CL 1
 PI STA. = 17+56.92
 Δ = 5° 43' 55" (RT)
 D = 2° 07' 19"
 T = 135.17
 L = 270.11
 R = 2,700.00
 PC STA. = 16+21.75
 PT STA. = 18+91.86
 e = NC

CURVE DATA EEW_CL 2
 PI STA. = 20+27.03
 Δ = 5° 43' 55" (LT)
 D = 2° 07' 19"
 T = 135.17
 L = 270.11
 R = 2,700.00
 PC STA. = 18+91.86
 PT STA. = 21+61.97
 e = NC

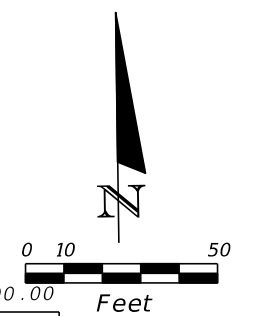

REVISIONS			
DATE	DESCRIPTION	DATE	DESCRIPTION

HORIZON ENGINEERING GROUP, INC.
 2603 Maitland Center Pkwy., Suite B
 Maitland, Florida 32751
 Phone: 407-644-7755
 Certificate of Authorization No.: 00009544
 JOSEPH ROSELLI, P.E. NO. 72227

STATE OF FLORIDA DEPARTMENT OF TRANSPORTATION		
ROAD NO.	COUNTY	FINANCIAL PROJECT ID
	SEMINOLE	439682-4-52-01

**SIGNING AND PAVEMENT
 MARKING PLAN (1)**

SHEET NO.
 S-4

THE OFFICIAL RECORD OF THIS SHEET IS THE ELECTRONIC FILE DIGITALLY SIGNED AND SEALED UNDER RULE 61G15-23.004, F.A.C.

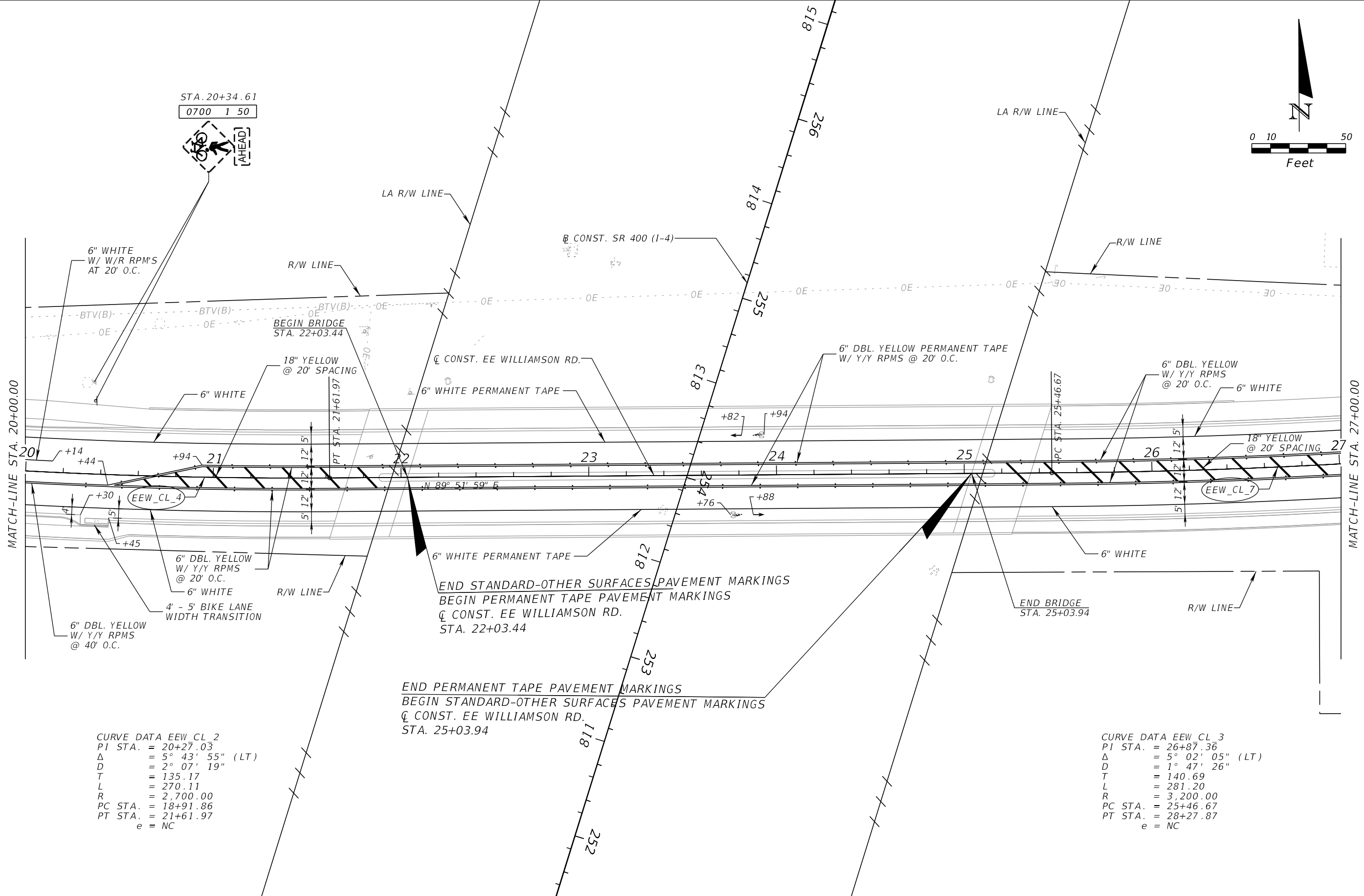
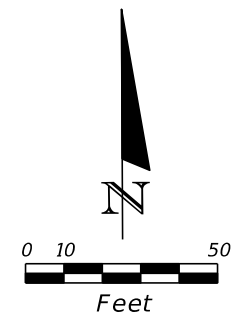

CURVE DATA EEW CL 2
 PI STA. = 20+27.03
 Δ = 5° 43' 55" (LT)
 D = 2° 07' 19"
 T = 135.17
 L = 270.11
 R = 2,700.00
 PC STA. = 18+91.86
 PT STA. = 21+61.97
 e = NC

CURVE DATA EEW CL 3
 PI STA. = 26+87.36
 Δ = 5° 02' 05" (LT)
 D = 1° 47' 26"
 T = 140.69
 L = 281.20
 R = 3,200.00
 PC STA. = 25+46.67
 PT STA. = 28+27.87
 e = NC

END STANDARD-OTHER SURFACES PAVEMENT MARKINGS
 BEGIN PERMANENT TAPE PAVEMENT MARKINGS
 Q CONST. EE WILLIAMSON RD.
 STA. 22+03.44

END PERMANENT TAPE PAVEMENT MARKINGS
 BEGIN STANDARD-OTHER SURFACES PAVEMENT MARKINGS
 Q CONST. EE WILLIAMSON RD.
 STA. 25+03.94

REVISIONS			
DATE	DESCRIPTION	DATE	DESCRIPTION

HORIZON ENGINEERING GROUP, INC.
 2603 Maitland Center Pkwy., Suite B
 Maitland, Florida 32751
 Phone: 407-644-7755
 Certificate of Authorization No.: 00009544
 JOSEPH ROSELLI, P.E. NO. 72227

STATE OF FLORIDA DEPARTMENT OF TRANSPORTATION		
ROAD NO.	COUNTY	FINANCIAL PROJECT ID
	SEMINOLE	439682-4-52-01

**SIGNING AND PAVEMENT
 MARKING PLAN (2)**

SHEET NO.
 S-5

THE OFFICIAL RECORD OF THIS SHEET IS THE ELECTRONIC FILE DIGITALLY SIGNED AND SEALED UNDER RULE 61G15-23.004, F.A.C.

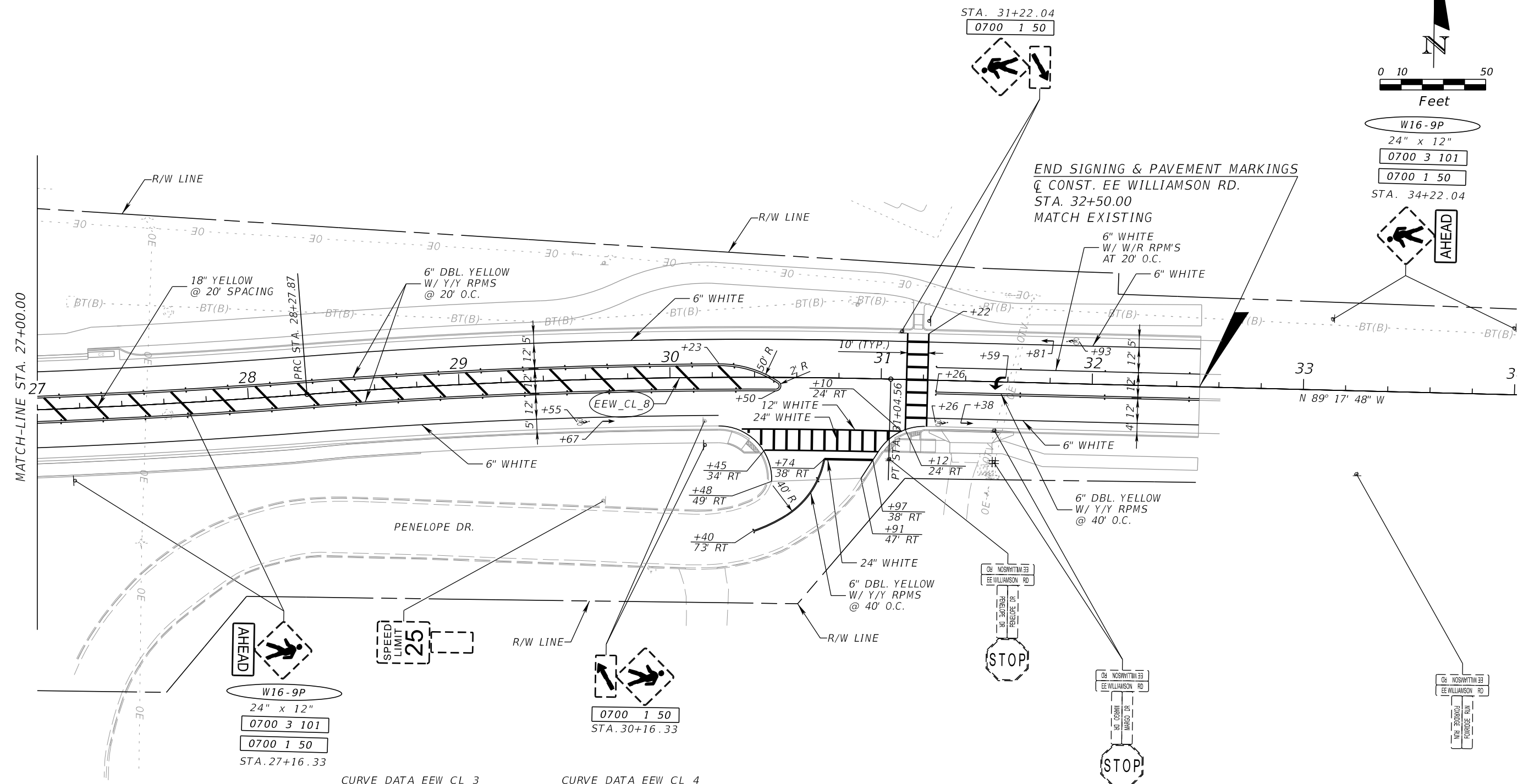
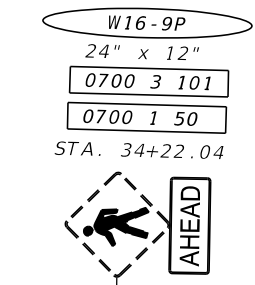
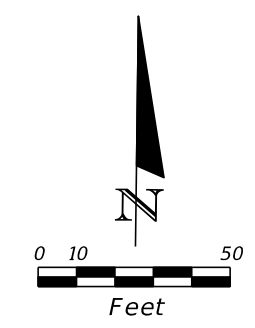

Curve ID	PI STA.	Delta	D	T	L	R	PC STA.	PT STA.	e
EEW_CL_3	26+87.36	5° 02' 05" (LT)	1° 47' 26"	140.69	281.20	3,200.00	25+46.67	28+27.87	NC
EEW_CL_4	29+66.34	5° 52' 18" (RT)	2° 07' 19"	138.47	276.70	2,700.00	28+27.87	31+04.56	NC

REVISIONS				HORIZON ENGINEERING GROUP, INC. 2603 Maitland Center Pkwy., Suite B Maitland, Florida 32751 Phone: 407-644-7755 Certificate of Authorization No.: 00009544 JOSEPH ROSELLI, P.E. NO. 72227	STATE OF FLORIDA DEPARTMENT OF TRANSPORTATION		SIGNING AND PAVEMENT MARKING PLAN (3)	SHEET NO. S-6
DATE	DESCRIPTION	DATE	DESCRIPTION		ROAD NO.	COUNTY		
					SEMINOLE	439682-4-52-01		

THE OFFICIAL RECORD OF THIS SHEET IS THE ELECTRONIC FILE DIGITALLY SIGNED AND SEALED UNDER RULE 61G15-23.004, F.A.C.