



BUILDING A BETTER I-4

Stay Informed:

- » Project Hotline: 321-988-9375
- » Follow @i4Ultimate on Twitter
- » Subscribe to our monthly newsletter at fdot.tips/I4News
- » Subscribe to our YouTube channel at youtube.com/i4Ultimate

EASTBOUND I-4 FROM DARYL CARTER PARKWAY TO CENTRAL FLORIDA PARKWAY SHIFTING SEPTEMBER 24

The Florida Department of Transportation (FDOT) is shifting traffic on eastbound Interstate 4 (I-4) roughly 12 feet towards the median of I-4 from Daryl Carter Parkway to Central Florida Parkway. Single and double lane closures on eastbound I-4 are scheduled to begin as soon as 9 p.m. Sunday, September 24 and are expected to be complete by 6:30 a.m. Monday, September 25. The closures are necessary to complete the shift. The traffic shift is anticipated to be in place until spring 2024 and will provide space for crews to complete drainage and lighting work.

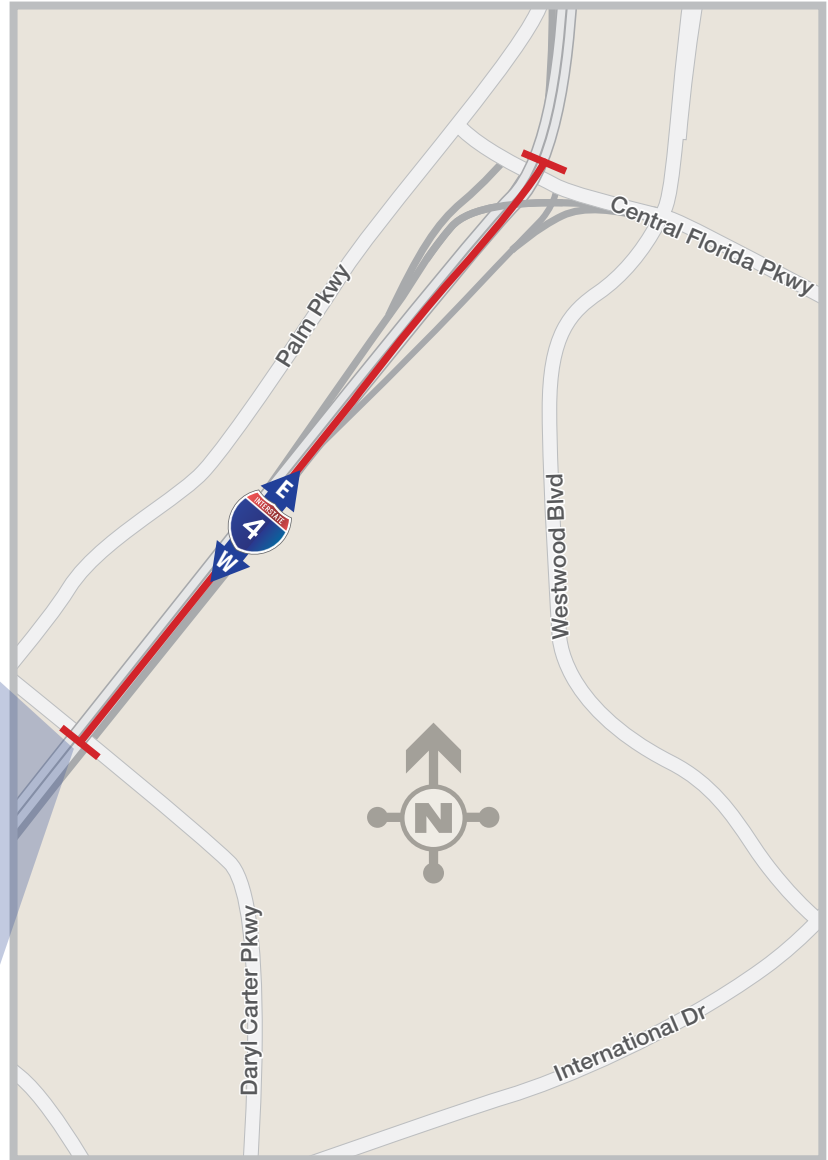

Eastbound I-4

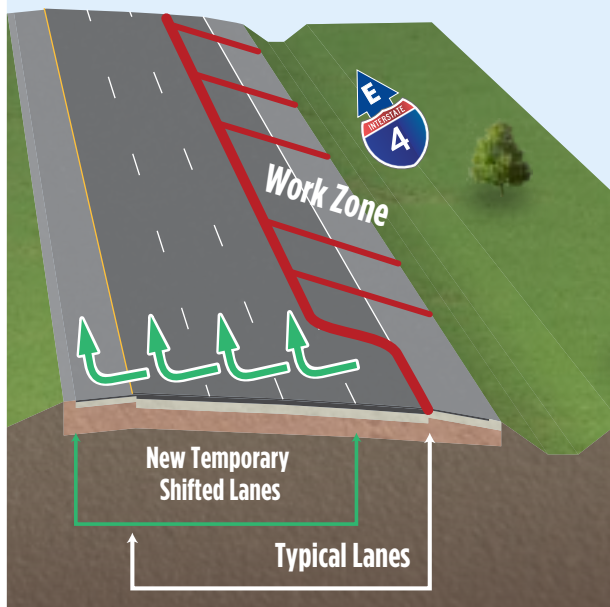

Closures are subject to change. Construction progress, roadway conditions and weather may require schedule adjustments. Please check fdot.tips/alertsmap for the most up-to-date information.



Visit I4Beyond.com/darylcarter to learn more about this project.

