

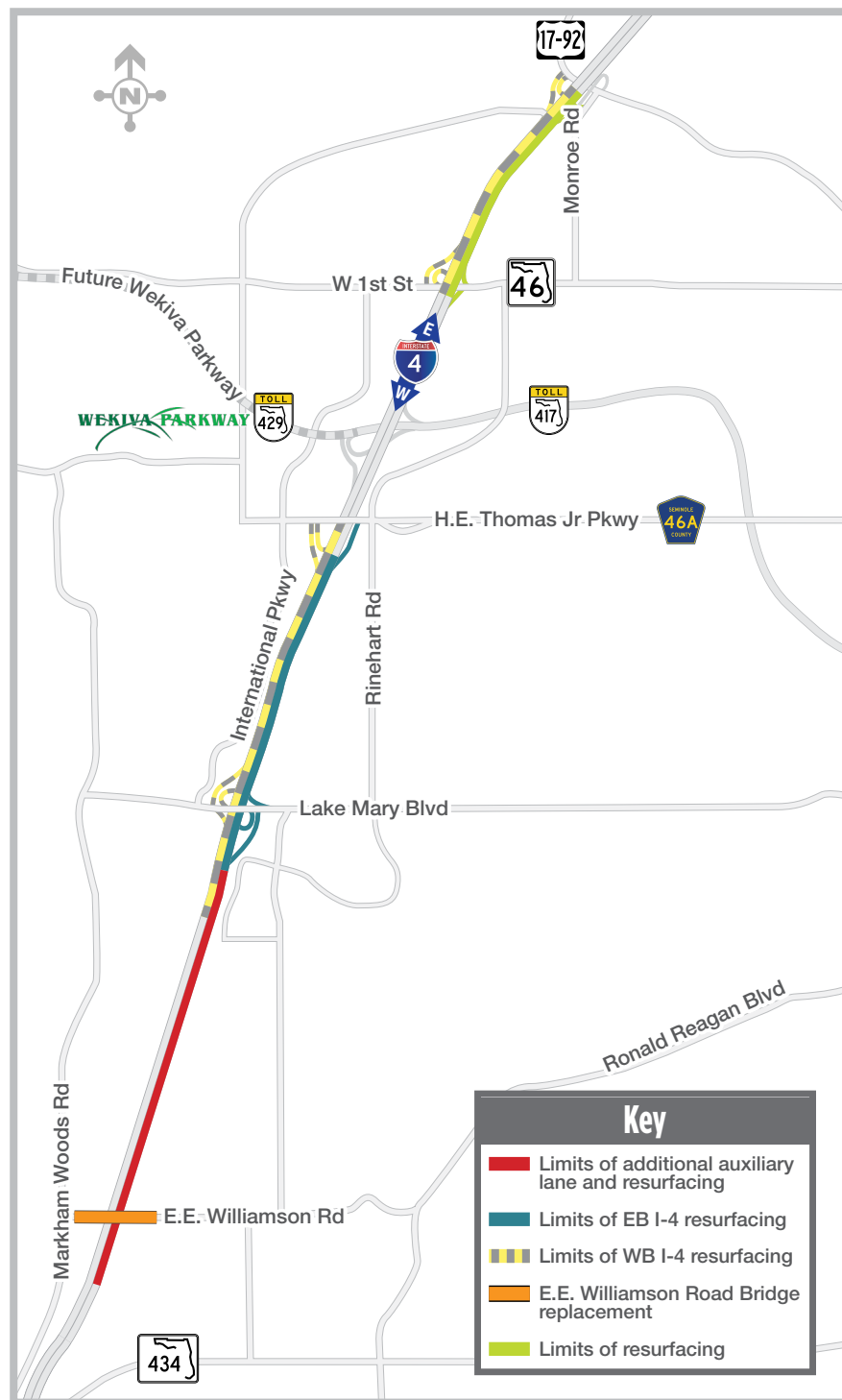

IMPROVEMENTS TO INTERSTATE 4 (I-4) IN SEMINOLE COUNTY

- » These projects will help accommodate traffic from the eastbound I-4 Ultimate Express Lanes as well as to extend the life of the existing pavement on I-4.
- » The eastbound I-4 auxiliary lane construction project includes the realignment of the eastbound I-4 exit ramp to Lake Mary Boulevard. (See reverse side for more information.)
- » Construction on eastbound I-4 began in September 2019. Construction on westbound I-4 is scheduled to begin in summer 2020.
- » During construction, lane closures on I-4 will be limited to overnight hours between 8 p.m. and 6:30 a.m.





BUILDING A BETTER I-4

Stay Informed:

- » Project Hotline: 844-ULT-INFO (858-4636)
- » Sign up for email and text alerts at fdot.tips/alerts
- » Subscribe to our monthly newsletter at fdot.tips/news
- » Follow us on Twitter at fdot.tips/twitter
- » Subscribe to our YouTube channel at fdot.tips/youtube

CURRENT

Current configuration of the eastbound I-4 exit to Lake Mary Boulevard is two right turn lanes: one to eastbound Lake Mary Boulevard and one to a right-turn-only lane to Lake Emma Road.



UNDER CONSTRUCTION

The configuration of the eastbound I-4 exit to Lake Mary Boulevard will be two right turn lanes. Both lanes take drivers to eastbound Lake Mary Boulevard. Once motorists are traveling on eastbound Lake Mary Boulevard, they can then choose to move to the right-turn-only lane to Lake Emma Road.

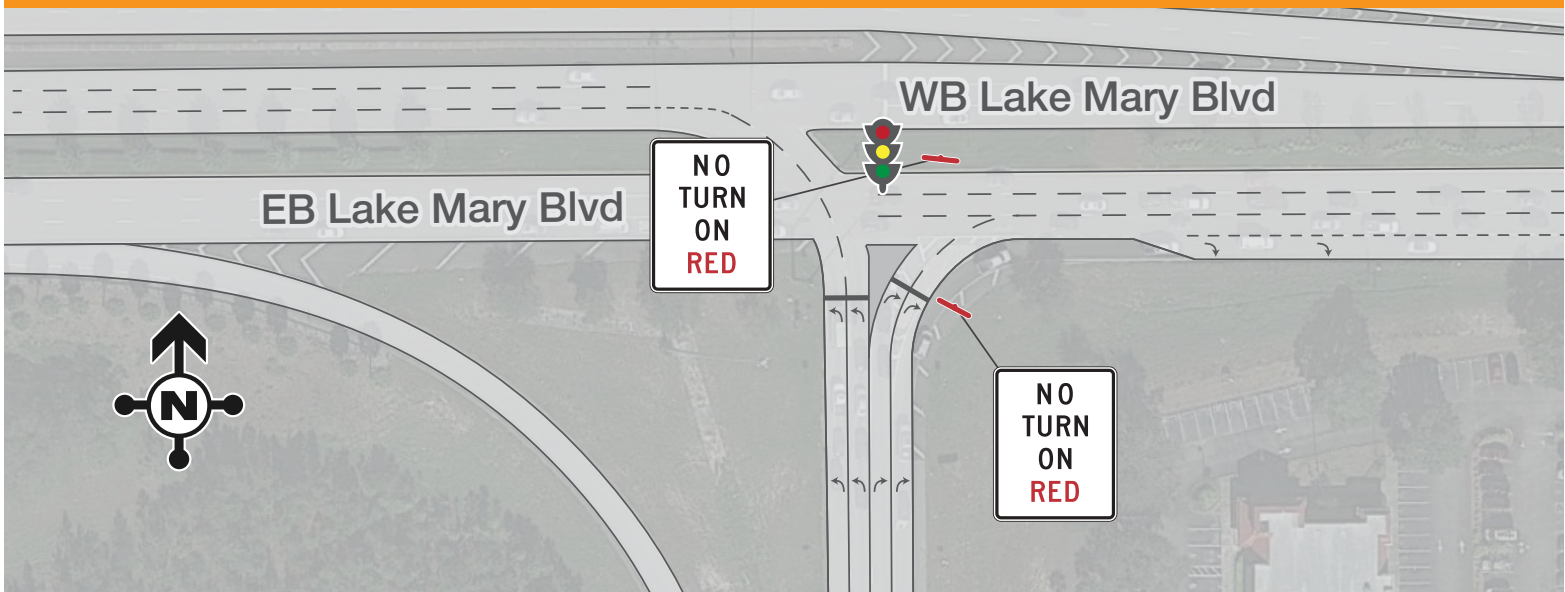

Sign up for I-4 Construction Updates and Alerts at I4Beyond.com
Learn about commuter options in Central Florida at reThinkYourCommute.com

reThink
your commute